

GST GEAR
www.gstgr.com



Professional Connectors & Cables
Revolutionizing the Future of Entertainment Together



Single Crystal Copper OCC Audio Cables



Model: A2M6-OCC



Model: A2S8-OCC

- Made with single crystal copper OCC, producing the world's top audio cables.
- During the transmission process, various audio and video signals passing through grain boundaries cause reflection and refraction, leading to signal distortion and attenuation. The minimal or absent grain boundaries in single crystal copper fundamentally improve transmission quality. Therefore, in the field of high-end audio and video equipment, we create the world's top connectivity solutions.
- Backbone of the national audio-visual connection industry.
- Let the world experience GST Cables.
- The world's top audio and video connection line.
- A2M6-OCC Single Crystal Copper Signal Cables: 0.10(128)2x40/0.10 O.D.6mm.
- A2S8-OCC Single Crystal Copper Audio Cables: 0.10x240x2 O.D.8mm.

Features

- High purity 99.9999%
- OCC



A608X1/OCC



A608X2/OCC



A608AX/OCC

Backbone of national video and audio connection enterprise
Let the world feel GST GEAR.

The world's top audio and video cables



Sufficient core sufficient meter/National standard certification

GST GEAR



GST GEAR cables is dedicated to the production, research and development, and sales of cables in three major fields: low-voltage cables, high-voltage cables, and integrated wiring. The product range includes: audio cables, speaker cables, HDMI fiber optic cables, HDMI high-definition cables, power cables, DMX signal control network cables, coaxial cables, flat cables, and various types of composite cables.



Microphone Cables



Features:

- The core wire is made of 99.99% OFC (Oxygen-Free Copper) stranded material.
- The cable sheath is made of PVC material, offering excellent wear resistance, acid and alkali resistance, and oil resistance.

Specification:

Model	Sheath Color	Core Structure	Shield Type	O.D
JM001	BK	(400.10BC)x2+AL+BD(128/0.10BC)	Braided	6mm
JM003	RD/BU/PL/OG/YL/BK	(32/0.10BC)x2+AL+BD(96/0.1BC)	Braided	6mm



Features:

- The core wire conductor is made of oxygen-free copper strands, offering excellent oxidation resistance and low attenuation. The sheath is made of elastic PVC, with internal filling of tensile cotton yarn. The spiral shielding provides more flexibility compared to braided shielding, making it resistant to twisting and preventing brittleness.

Specification:

Model	Sheath Color	Core Structure	Shield Type	O.D
JM004	RD/BU/PL/OG/YL/BK	(32/0.10BC)x2+AL+BD(96/0.10BC)	Spiral	6mm
JM006	BK	(18/0.10BC)x2+AL+BD(64/0.1BC)	Spiral	6mm



Features:

- The outer shielding of the core wire is made of tinned copper with high-density braiding. The 95% copper mesh effectively reduces electromagnetic noise. The outer sheath is made of elastic PVC, which feels soft and has bright colors.

Specification:

Model	Sheath Color	Core Structure	Shield Type	O.D
A2M6	BK	(400.10BC)x2+AL+BD(128/0.10TC)	Braided	6mm



Features:

- The core wire consists of four pairs of twisted strands, with the outer shielding made of tinned copper wire with high-density braiding. The mesh design distributes the bending force evenly across each copper strand, providing approximately 95% shielding efficiency. The material is resistant to oxidation, which helps extend its lifespan.

Specification:

Model	Sheath Color	Core Structure	Shield Type	O.D
A4M6	BK	(28/0.10BC)x4+AL+BD(128/0.10TC)	Braided	6mm

Microphone Cables



Features:

- The core wire conductor is made of oxygen-free copper strands, providing excellent oxidation resistance and low attenuation. The sheath is made of elastic PVC, with internal tensile cotton yarn filling. The spiral shielding is softer than braided shielding, offering better resistance to twisting and preventing brittleness.

Specification:

Model	Sheath Color	Core Structure	Shield Type	O.D
JA5500	BK	(32/0.10)x2+SD(40/0.10BC)	Spiral	5.0/10mm



Features:

- The ultra-thin PVC sheath has a diameter of 4mm, making it suitable for engineering wiring and saving conduit space. The professional twisting technology ensures high flexibility and excellent resistance to twisting.

Specification:

Model	Sheath Color	Core Structure	Shield Type	O.D
JM008	BK/GY	2x400.10+40/0.10Tin	Spiral	4mm
JM011	GY	2x400.10+96/0.10Tin	Spiral	4mm



Features:

- The dual shielding combines copper braided shielding with semiconductor shielding, with the outer layer of the core wire wrapped in conductive material. Due to the thicker PVC sheath, strain is reduced, and the cable offers good bend resistance.

Specification:

Model	Sheath Color	Core Structure	Shield Type	O.D
AG-6	BK/BU/OG	128/0.10+BD(128/0.10)	Braided	6mm
JG005	BK	50/0.10+BD(96/0.10)	Braided	6mm



Features:

- The twisted sheath speaker cable uses oxygen-free copper strands, effectively reducing radiation noise. The insulation material lowers conductivity and compensates for frequency response characteristics.

Specification:

Model	Sheath Color	Core Structure
JA300	GY	2x1.0mm ²
JA301	GY	2x1.5mm ²
JA302	GY	2x2.0mm ²
JA303	GY	2x2.5mm ²

Model	Sheath Color	Core Structure
JA305	GY	2x4.0mm ²
JA308	GY	4x2.5mm ²
JA309	GY	4x4.0mm ²

Audio Cables



Features:

- Elastic PVC sheath with cotton yarn filling, oxygen-free copper wire bundles twisted, compact, moisture-resistant, and low-temperature resistant.

Specification:

Model	Sheath Color	Core Structure	O.D
JA102	Black Dark Blue	2x1.0mm ²	8mm
JA103	Black Dark Blue	2x1.5mm ²	8.5mm
JA104	Black Dark Blue	2x2.0mm ²	9mm
JA105	Black Dark Blue	2x2.5mm ²	10mm
JA106	Black Dark Blue	2x4.0mm ²	12mm
JA107	Black Dark Blue	4x1.0mm ²	10mm
JA108	Black Dark Blue	4x1.5mm ²	11mm
JA109	Black Dark Blue	4x2.5mm ²	12mm
JA110	Black Dark Blue	6x1.5mm ²	12.5mm
JA111	Black Dark Blue	6x2.5mm ²	14.5mm
JA112	Black Dark Blue	8x1.5mm ²	14mm
JA113	Black Dark Blue	8x2.5mm ²	15.5mm
JA114	Black Dark Blue	4x2.0mm ²	11.5mm
JA115	Black Dark Blue	4x4.0mm ²	14.2mm



Features:

- High-quality transparent double-row speaker cable, oxygen-free copper/tinned copper conductor, soft PVC outer sheath.
- Conductors bare copper/tinned OFC.

Specification:

Model	Sheath Color	Core Structure	O.D
JA2003	Transparent	2x50x0.10mm ²	3.06.0mm
JA2004	Transparent	2x100x0.10mm ²	3.57.0mm
JA2005	Transparent	2x150x0.10mm ²	4.08.0mm
JA2006	Transparent	2x200x0.10mm ²	4.28.4mm
JA2007	Transparent	2x250x0.10mm ²	4.48.8mm
JA2008	Transparent	2x300x0.10mm ²	4.69.2mm



Features:

- Elastic PVC sheath, oxygen-free copper conductor, flat shape, easy installation.

Specification:

Model	Sheath Color	Core Structure	O.D
JA510C	Wine Red	2x100x0.08mm ²	3.67.2mm
JA5150	Wine Red	2x150x0.08mm ²	4.08.0mm
JA5200	Wine Red	2x200x0.08mm ²	4.48.8mm

Multicore Audio Cables



Features:

- Elastic PVC outer sheath, each channel independently shielded with aluminum foil and copper mesh for high noise reduction, ideal for stage performances and AV installations.
- Internal guiding wire for easy and convenient termination, with environmentally friendly polyethylene elastic insulation, offering softness, toughness, and excellent electrical insulation.

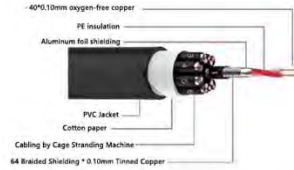

Specification:

Voltage	Must Withstand at DC 125V/15sec.
IMPEDANCE(Ω)	214Ω/KM
Applicable Temperature	-20°C~70°C(-4° F+158° F)
PART NO	200.100FE
CONDUCTOR SIZE	0.16MM(25AWG)
DETAILS	[(200.100FC+PE1.1)*2C+DW7/10.15TC+A LFOIL+PVC3.0]*CHANNEL+JACKET PVC

Model	Channel	O.D
DJ004/DJ004C	4	10mm
DJ006/DJ006C	6	12mm
DJ008/DJ008C	8	13mm
DJ010	10	15mm
DJ012	12	15.5mm
DJ016	16	18mm
DJ020	20	20mm
DJ022	22	22mm
DJ024	24	22mm
DJ028	28	23.5mm
DJ030	30	25mm
DJ032	32	26mm
DJ036	36	27mm
DJ038	38	27mm
DJ040	40	28mm
DJ042	42	29mm
DJ044	44	29mm
DJ048	48	30mm
DJ050	50	31mm

DJ004C



Six Dual-shielded 2-8 Channel Network Cables



Features:

- Elastic PVC outer sheath, each channel shielded with aluminum foil + copper mesh; precise twisting control effectively eliminates signal crosstalk and reduces attenuation.
- Reduced return loss, improved electrical performance, and resistance to external electromagnetic interference, ensuring high-speed and stable signal transmission.
- Finished network cables pass Fluke testing, with stable crimping and 100% performance testing, making it the best choice for rental screens.

Specification:

Order Code	Channel	Length
DC-CAT6-2	2	20m
DC-CAT6-2	2	30m
DC-CAT6-2	2	50m
DC-CAT6-2	2	80m
DC-CAT6-4	4	30m
DC-CAT6-4	4	50m
DC-CAT6-4	4	80m
DC-CAT6-6	6	30m
DC-CAT6-6	6	50m
DC-CAT6-6	6	80m
DC-CAT6-8	8	30m
DC-CAT6-8	8	50m
DC-CAT6-8	8	80m

Coaxial Line



Features:

- Standard coaxial cable design for high-speed signal transmission, with dual-layer shielding to reduce interference, resulting in clearer image quality with minimal signal attenuation.
- Shielding: Aluminum foil + 99.99% tinned oxygen-free copper wire with ultra-dense braided shielding, effectively blocking external interference and reducing crosstalk and return loss.
- Core wire: 99.99% oxygen-free copper, oxidation-resistant, low attenuation, and fast transmission speed.
- Sheath: High-elastic PVC environmental insulation layer, soft, durable, non-brittle, wear-resistant, oil-resistant, and corrosion-resistant, extending the cable's lifespan.
- PE transparent insulation layer, low eccentricity, reduces crosstalk, and prevents electrical breakdown.
- Meter markers: Bidirectional meter markers with clear printing, ensuring accurate measurements to reduce errors, saving time and labor during installation.
- Compliant with international standards, providing reliable use.
- ROHS 2.0 Enhanced Certification.
- ISO9001:2015 Certification.

Specification:

Model	Shield Type	Core Structure	O.D
50-3	128 Braided	(20/0.20BC)BD+(128/0.10BC)	Φ5.3mm
50-5	144 Hyper Braided	(55/0.20BC)BD+(144/0.10BC)	Φ7.3mm
75-3	128 Braided	(7/0.20BC)BD+(128/0.10BC)	Φ5.5mm
75-5	144 Braided	(31/0.20BC)BD+(144/0.10BC)	Φ7.3mm

Eight Core Hand in Hand Conference Microphone Line



Features:

- The conductor is made of high-purity OFC oxygen-free copper, offering low signal attenuation, minimal signal loss, and high transmission speed for complete signal transmission.
- The sheath and insulation layer use new plastic materials, offering excellent wear resistance, acid and alkali resistance, oil resistance, and a long service life.
- Aluminum foil + braided double-layer shielding, with low loss and better audio transmission quality.
- **Application fields:** Amplifiers, audio equipment, and more. Suitable for home use, karaoke, conference rooms, public address systems, and other audio engineering projects.

Specification:

Model	Shield Type	Core Structure	O.D
JM800	128 Braided	(7/0.19BC)BD+(128/0.10BC)	Φ6.8mm

Stage Lighting Flat Cable



Application:

- Suitable for multi-functional lighting suspension rods' vertical folding wiring and horizontal centralized wiring in large venues such as television studios, theaters, and sports arenas. It offers easy and neat cable deployment with a simplified and aesthetically pleasing wiring space.
- The system can be customized to combine with 3-core or 5-core DMX512 signal cables, Cat 5e or Cat 6 shielded network cables, and fiber optic cables as per customer requirements.

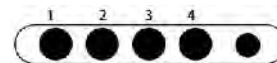

ZR-YJV-4*35mm²+1*16mm²

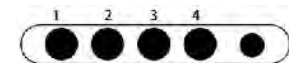

ZR-YJV-4*120mm²+1*70mm²

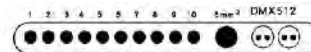

ZR-YJV-10*4mm²+6mm²+2*(2*0.3mm²)

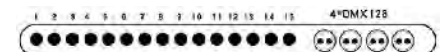

ZR-EVR-15*4mm²+DMX128 4*(2*0.5mm²)

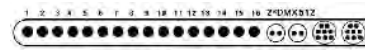

16*4mm²+2*mm²+2*DMX512+2*CAT5E

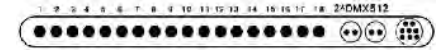

18*2.5mm²+2*DMX512+1*CAT5E

Flame Retardant Cable for Stage Design



Features:

- High-quality flame-retardant cables for stage lighting, with an environmentally friendly, flame-retardant elastomer sheath that offers excellent flame resistance, flexibility, and wear resistance.
- Thick, high-precision oxygen-free copper conductors with larger cross-sectional areas for higher current carrying capacity and lower resistance.
- Manufactured with advanced equipment and strict quality control, ensuring low eccentricity and uniform outer sheath thickness to prevent electrical breakdown and ensure electrical safety.
- Consistent appearance with uniform thickness and clear cable markings to ensure accurate length.
- High-quality flame-retardant cables for stage lighting, serving global broadcast institutions, sports venues, theaters, concert halls, conference rooms, KTV, and other locations.

Plug-in Cable for Performance System



Features:

- High-quality flame-retardant cables with an environmentally friendly, flame-retardant elastomer sheath, offering superior electrical performance, aesthetic appeal, and corrosion resistance.
- Thick, high-precision oxygen-free copper conductors with larger cross-sections for higher current capacity and lower resistance.
- Customizable with various connectors to meet user needs, widely used in TV stations, theaters, sports venues, and performance spaces. Ideal for powering silicon boxes, dimmer cabinets, and quick lighting wiring.



Specification Size and Technological Data

60227IEC 06(RV) Rated Voltage 300/500V Cable Comprehensive Data

Nominal Cross Sectional Area of Conductors(mm ²)	Number /Diameter of The Core(mm)	Average Da.(mm)		Reference Weights (Kg/Km)	Conductor Resistance at 20°C (Ω/km Max.)
		Min.	Max.		
0.5	16*0.2	2.1	2.5	9.1	36.0
0.75	24*0.2	2.2	2.7	12.2	24.5
1.0	32*0.2	2.4	2.8	15.1	18.1

60227IEC 52(RV) Rated Voltage 300/300V Cable Comprehensive Data

Nominal Cross Sectional Area of Conductors(mm ²)	Number /Diameter of The Core(mm)	Average Da.(mm)		Reference Weights (Kg/Km)	Conductor Resistance at 20°C (Ω/km Max.)
		Min.	Max.		
2*0.5	16*0.2	4.6/3.0*4.9	5.9/3.7*5.9	31.5	39.0
2*0.75	24*0.2	4.9/3.2*5.2	6.3/3.8*6.3	40.0	26.0
3*0.5	16*0.2	3.9	4.8	40.6	39.0
3*0.75	24*0.2	4.4	5.3	51.8	26.0

60227IEC 02(RV) Rated Voltage 450/750V Cable Comprehensive Data

Nominal Cross Sectional Area of Conductors(mm ²)	Number /Diameter of The Core(mm)	Average Da.(mm)		Reference Weights (Kg/Km)	Conductor Resistance at 20°C (Ω/km Max.)
		Min.	Max.		
1.5	48*0.2	2.8	3.4	21.5	13.3
2.5	80*0.2	3.4	4.1	24.5	7.98
4	128*0.2	3.9	4.8	51.8	4.95
6	191*0.2	4.4	5.3	74.7	3.3
10	318*0.2	5.7	6.8	124	1.91
16	508*0.2	6.7	8.1	188	1.21
25	794*0.2	8.4	10.2	296	0.780
35	1114*0.2	9.7	11.7	400	0.554
50	1588*0.2	11.5	13.9	547	0.386
70	2228*0.2	13.2	16.0	771	0.272
95	3020*0.2	15.1	18.2	1010	0.206
120	3818*0.2	16.7	20.2	1239	0.161
150	4770*0.2	18.6	22.5	1544	0.129
185	5880*0.2	20.6	24.9	1900	0.106
240	7630*0.2	23.5	28.4	2478	0.080

60227IEC 53(RV) Rated Voltage 300/500V Cable Comprehensive Data

Nominal Cross Sectional Area of Conductors(mm ²)	Number /Diameter of The Core(mm)	Average Da.(mm)		Reference Weights (Kg/Km)	Conductor Resistance at 20°C (Ω/km Max.)
		Min.	Max.		
2*0.75	24*0.2	5.7/3.7*6.0	7.2/4.5*7.2	50	26
2*1.0	32*0.2	5.9/3.9*6.2	7.8/4.7*7.5	55	19.5
2*1.5	48*0.2	6.8	8.6	60	13.3
2*2.5	80*0.2	8.4	10.6	100	7.98
3*0.75	24*0.2	6.0	7.6	55	26
3*1.0	32*0.2	6.3	8.0	60	19.5
3*1.5	48*0.2	7.4	9.4	95	13.3
3*2.5	80*0.2	9.2	11.4	140	7.98
4*0.75	24*0.2	6.6	8.3	60	26
4*1.0	32*0.2	7.1	9.0	70	19.5
4*1.5	48*0.2	8.4	10.5	120	13.3
4*2.5	80*0.2	10.1	12.5	260	7.98
5*4.0	127*0.2	16	19	320	4.95
5*6.0	190*0.2	19	31	450	3.3
5*10	318*0.2	20	24	750	1.91
5*16	508*0.2	25	28	1300	1.21
15*25	795*0.2	34	37	1900	0.78

RVVP Double Shield (Engineering) Cable RVVP



Features:

- RVVP type polyethylene-insulated, PVC-sheathed, double-shielded power cable.
- Uses aluminum foil and 99.99% oxygen-free copper braided shield for effective external interference shielding and minimal crosstalk loss.
- Made from special PVC material, offering excellent insulation and high tensile strength.

Application Area:

Suitable for communication, audio, broadcasting systems, computers, instruments, electronic devices, and automation equipment requiring shielded cables to prevent interference.

Specification(RVVP/RVSP/WDZRVVP /WDZRVVSP):

Nominal Cross Sectional Area of Conductors(mm ²)	Number /Diameter of The Core(mm)	Average Dia. (mm)		Reference Weights (Kg/Km)		Conductor Resistance at 20°C (Ω/Km Max.)
		Min.	Max.			
2*0.5	2*16*0.20	5.5	6.4	34.4	48.4	36
2*0.75	2*24*0.20	5.8	6.6	65	65	24.5
2*1.0	2*32*0.20	5.9	7.5	74	74	18.1
2*1.5	2*48*0.20	6.8	8.6	92	92	12.1
3*0.5	3*16*0.20	5.6	6.6	57	57	36
3*0.75	3*24*0.20	6	7.6	80	80	24.5
3*1.0	3*32*0.20	6.3	8	93	93	18.1
3*1.5	3*48*0.20	7.4	9.4	125	125	12.1
4*0.5	4*16*0.20	5.8	7.8	83	83	36
4*0.75	4*24*0.20	6.6	8.3	95	95	24.5
4*1.0	4*32*0.20	7.1	9	116	116	18.1
4*1.5	4*48*0.20	8.4	10.5	155	155	12.1
6*1	6*32*0.20	9.7	12	170	170	12.1
8*1	8*32*0.20	11.4	14.2	200	200	12.1

Special Power Cord & Combination Cable



Combination cables of power cables and signal cables.

Power cord and network cable combination cable.



Power cord network cable combination cable.



Network cable combination cable.



Spring cable of various specifications.

Advanced shielded power cord.

Combination cables of power cables and signal cables.



4CH Audio/DMX or network cable extender.



Recording sound card analog audio DB25 switching cable.



Power Box Series

Application:

- The High-end Power Cabinets: Ensuring Safety for Every Stage Event.
The through-power distribution box features a dual-layer shockproof casing with a reinforced base, making it durable and ideal for mobile performances. All components, including connectors, circuit breakers, and wires, are assembled with high-quality, renowned brand parts, ensuring stability during use. Standard configurations include a voltage and current meter, LED lighting, multifunction sockets, and a premium dust cover for power inputs, designed for user convenience.

Features:

- High-quality dual-layer shockproof casing with silent wheels
- Weipu 16A 3-pin waterproof socket
- High-end 19-pin female output
- Conni 400A Rhino plug input
- Transparent, high-quality Conni protective cover for inputs
- Delixi circuit breaker
- Clearly marked layout for circuit breakers and corresponding controlled outputs
- Maximized output with minimal height control
- Standard configuration with dual-sided U-shaped LED lighting
- Standard configuration with phase-separated output circuit indicator lights
- Standard configuration with a three-phase voltage and current integrated meter
- Standard configuration with multifunction sockets for balanced three-phase output
- National standard high-quality flame-retardant cables
- Organized wiring, reasonable layout, and easy maintenance



6 Fers Power Rack



9 Fers Power Rack



5U 12 Channel



9U 24 Channel



48 Channel



Waterproof power supply through box

Power Connectors

10A 40A Bakelite Coupling Plug



16A 32A Three-Pin Coupling Plug



32A 63A Two-Pin Coupling Plug



32A 63A Five-Pin Coupling Plug



Waterproof 16A Power Connector



16A 32A Three-Pin Coupling Plug



400A Cam Lock



19-Pin Power Coupling Plug



CAT5E Network Cable



Application:

- This series of products is widely used in various network cabling structures and transmission media, including audio, digital, text, image, and video communications, suitable for high-speed, high-capacity, secure, and confidential local network environments.

Features:

- IEC 61156, TIA 568-C.2, YD/T 1019-2013, ISO/IEC 11801
- Operating temperature: -20° C to +70° C
- Complies with TIA 568-C.2 standards for 100MHz testing, expandable to 350MHz, with a transmission frequency of 100MHz.
- Widely applied in network integrated cabling and digital communication, supporting intelligent transmission with high speed and stability, fully supporting duplex network signal transmission in smart building cabling installations.
- Conductors made from high-purity refined copper using high-end integrated forming equipment, ensuring minimal signal insertion loss, fast speeds, and high transmission rates with broad bandwidth.
- Outer jacket made from high-quality PVC material, enhancing product longevity.
- Available in UTP (unshielded), FTP (single-shielded), and SFTP (double-shielded) product types.

Material Model Specifications	Conductor Structure (No./mm)	Conductor Material	cable Gauge	Insulation O.D.(mm)	Insulation Material	Insulation Color	Shield Type	Weave Density	Sheathing Material	Sheathing O.D.(mm)	Packing Length (m/r)
UTP CAT 5e	1/0.50	Annealed Round Copper	23AWG	0.9	HDPE	White Blue/ White Orange/ White Green/ White Brown/ Brown	/	/	PVC	Φ5.1±0.15	305m per
UTP CAT 5e	1/0.50			0.9			/	/		Φ5.1±0.15	
FTP CAT 5e	1/0.51			1.03			Wheat Grain + Ground cable + Aluminum Foil	/		Φ6.5±0.20	
FTP CAT 5e	1/0.51			1.03			Wheat Grain + Ground cable + Aluminum Foil	/		Φ6.5±0.20	
SFTP CAT 5e	1/0.51			1.03			Wheat Grain + Ground cable + Aluminum Foil	≥49%		Φ6.8±0.20	
SFTP CAT 5e	1/0.51			1.03			Wheat Grain + Ground cable + Aluminum Foil	≥49%		Φ6.8±0.20	

Frequency (MHz)	Impedance (Ω)	Return Loss (dB)	Attenuation (dB/100m)	Near-end Crosstalk (dB)	Near-end Crosstalk Power Sum (dB)	Equivalent far-end Crosstalk (dB)	Equivalent far-end Crosstalk Power Sum (dB)
0.772	100 ± 15	-	1.8	67.0	64.0	66.0	63.0
1.0		20.0	2.0	65.3	62.3	63.8	60.8
4.0		23.0	4.1	56.3	53.3	51.7	48.7
8.0		24.5	5.8	51.8	48.8	45.7	42.7
10.0		25.0	6.5	50.3	47.3	43.8	40.8
16.0		25.0	8.2	47.3	44.3	39.7	36.7
20.0		25.0	9.3	45.8	42.8	37.7	34.7
25.0		24.3	10.4	44.3	41.3	35.8	32.8
31.25		23.6	11.7	42.9	39.9	33.9	30.9
62.5		21.5	17.0	38.4	35.4	27.8	24.8
100.0		20.1	22.0	35.3	32.3	23.8	20.8

Super 6 types 4 Pairs Bi-braiding cable



CAT6/CAT6A Network Cable

- Conductors are made from high-purity refined copper using high-end integrated production equipment, ensuring minimal signal insertion loss, fast speeds, and high transmission rates with broad bandwidth.
- The outer jacket is made from high-quality polyvinyl chloride (PVC), enhancing product longevity.
- The special cross-frame structure maintains stable cable pair positioning, reducing crosstalk and maintaining stable impedance.
- The **Category 6** product series includes UTP (unshielded) and SFTP (double-shielded) types, while the **Category 6A** series includes UTP (unshielded), FTP (single-shielded), and SFTP (double-shielded) types.

Application:

- This series of products is specifically designed to address crosstalk between cables in Gigabit Ethernet cabling systems, featuring twisted pairs and a unique cross-shaped structure with shielding.
- The design provides excellent shielding and electromagnetic interference resistance, making it widely applicable in large-capacity network cabling structures and high-point transmission media such as audio, digital, text, image, and video communications in high-speed, high-capacity, secure, and confidential local network environments.

Features:

- IEC61156 TIA568-C.2 YD/T1019-2013 IS011801
- Suitable for -20° C to +70° C.
- Category 6 Cables comply with TIA 568-C.2, tested at 250MHz and expandable to 550MHz. Category 6A Cables comply with TIA 568-C.2, tested at 500MHz.
- Intelligent transmission, high speed, and stability, fully supporting duplex network signal transmission, with transmission frequencies of 250MHz/500MHz. Widely used in network integrated cabling, digital communication networks, and smart building cabling installations.

Material Model Specifications	Conductor Structure (No./mm)	Conductor Material	Cable Gauge	Insulation O.D.(mm)	Insulation Material	Insulation Color	Shield Type	Weave Density	Sheathing Material	Sheathing O.D.(mm)	Packing Length (m/r)
UTP CAT6	1/0.57	Annealed Round Copper	23AWG	1.04	HDPE/EP	White Blue/ Blue White Orange/ White Green/ White Brown/ Brown	/	/	PVC	Φ6.2±0.20	305m per
UTP CAT6	1/0.57			1.04			/	/		Φ6.2±0.20	
SFTP CAT 6A	1/0.57			1.15			Wheat Grain + Aluminum Foil + Braiding	≥46%		Φ7.8±0.20	
SFTP CAT 6A	1/0.57			1.15			Wheat Grain + Aluminum Foil + Braiding	≥46%		Φ7.8±0.20	

Frequency (MHz)	Impedance (Ω)	Return Loss (dB)	Attenuation (dB/100m)	Near-end Crosstalk (dB)	Equivalent far-end Crosstalk (dB)
0.772	100 ± 15	19.4	1.6	76.0	70.2
1.0		20.0	1.8	74.3	68.0
4.0		23.0	3.7	65.3	56.0
8.0		24.0	5.3	60.8	49.9
10.0		25.0	5.9	59.3	48.0
16.0		25.0	7.5	56.2	43.9
20.0		25.0	8.6	54.8	42.0
25.0		24.3	9.5	53.3	40.0
31.25		23.6	10.6	51.9	38.1
62.5		21.5	15.4	47.4	32.1
100.0		20.1	19.8	44.3	28.0
200.0		18.0	29.0	39.8	22.0
250.0		17.3	32.8	38.3	20.0

CAT6/CA T6A Network Cable

Material Model Specifications	Conduct or Structure (No./m ²)	Conduct or Material	Cable Gauge	Insulation O.D.(m/m)	Insulation Material	Insulation Color	Shield Type	Weave Density	Sheathing Material	Sheathing O.D.(mm)	Packing Length (m/r)
UTP CAT 6A	1/0.58	Annealed Round Copper	23AWG	1.04	FEP	White Blue/White Orange/White Green/White Brown/Brown	/	/	LS-FR PVC	Φ7.4±0.20	305m per
F/UTP CAT 6A	1/0.58			1.04		/	/	PVC LSZH	Φ7.9±0.20		
SFTP CAT 6A	1/0.58			1.35		Wheat Grain + Aluminum Foil + Braiding	≥46%	PVC LSZH	Φ8.0±0.20		

Frequency (MHz)	Impedance (Ω)	Return Loss (dB)	Attenuation (dB/100m)	Near-end Crosstalk (dB)	Equivalent far-end Crosstalk (dB)
1.0	100±15	20.0	2.1	74.3	68.0
4.0		23.0	3.8	66.3	56.0
16.0		25.0	7.5	57.2	44.0
20.0		25.0	8.4	55.8	42.0
31.25		23.6	10.5	52.9	38.0
62.5		21.5	15.0	48.4	32.0
100.0		20.1	19.1	45.3	28.0
250.0		17.3	31.1	39.3	20.0
500		15.2	45.3	34.8	14.0

Passed the Fluke test



Super 8 Types 4 Pairs Bi-braiding cable



Application:

- Utilizes triple-layer co-extruded physical foaming technology to reduce attenuation, resist oxidation, and ensure faster transmission during 10G data transfers.
- Features 4N-grade oxygen-free copper cores with single-strand copper wire diameters of 0.60mm ± 0.02mm. Thicker wires result in lower electrical resistance and better transmission performance.
- Precisely controlled twist pitches effectively counteract crosstalk between pairs, reduce attenuation and return loss, and enhance the cable's electrical performance while resisting external electromagnetic interference for high-speed, stable signal transmission.
- Ideal for high-speed broadband environments such as data centers and bandwidth-intensive locations. Despite shorter transmission distances, it offers distinct advantages.
- Category 8 cables can share RJ45 ports, enabling seamless upgrades from 1G to 10G, 25G, and 40G network speeds.
- These cables are plug-and-play and can be terminated on-site like other cable categories, making deployment easy.
- In practical use, Category 8 cables are more convenient than optical fiber jumpers for 25G/40GBASE-T networks at transmission distances under 30 meters.

Features:

- IEC61156 TIA568-5YD/T1019-2013 ISO11801
- Suitable for -20° C to +70° C.



Network Cable Jumper



CAT6 shield cable



CAT6 shield cable



Network cable jumper

Features:

- Multi-strand conductor structure, making the jumper cable flexible, easy to bend, and resistant to breakage.
- Gold-plated crystal head contacts ensure excellent performance.
- Extended, gradient stress design of the jacket, non-slip and tensile-resistant, ensuring a specified bending radius.
- Interlaced pin design reduces crosstalk.
- Unique anti-hook jacket design for easy use.
- Available in various lengths and colors for easy color management.

Application Area:

- Cabinet jumpers, structured cabling, office wiring in complex electromagnetic environments, and environments requiring shielding as per specifications.



CAT5 Network cable jumper

Features:

- Supports 2000MHz wide frequency, 40Gbps light-speed transmission rate, ultra-high bandwidth.
- Three-layer co-extruded physical foam technology reduces attenuation, resists oxidation, and speeds up transmission during 10Gbps transmission.
- Each pair of conductors features independent aluminum foil shielding, oxygen-free copper grounding wire double shielding, tin foil full-wrap triple shielding, and tinned copper braid quadruple shielding, reducing crosstalk between conductors.
- 4N-grade oxygen-free copper conductors. Single copper wire core with a diameter of $0.60\text{mm} \pm 0.02\text{mm}$, precise four pairs, 8-core twisted pair structure, improving the cable's electrical performance and resisting external electromagnetic interference, ensuring stable and high-speed signal transmission.
- The connector uses a 40Gbps light-speed transmission rate, Class 8, metal shielding outer shell, with gold-plated tri-chip design to reduce external electromagnetic interference and maintain stable performance; designed for crimp-free usage.
- Tested with Fluke instruments.

Application Area:

- Cloud data centers, enterprise network wiring, home NAS networks, high-end internet cafes, network live streaming, high-fidelity audio/video equipment, etc.

Crystal Head



Category 7 Crystal Head



Shielded Category 6 Crystal Head



Crystal Head

Connecting the world through GST GEAR audio and video

Audio and Video Finished Product Connecting Line



More efficient • More durable
Audio and video finished product connection line





MA001

3P XLR female-3P XLR male



Description	Order Code	Length
High performance prebalanced microphone cable with GST GEAR connectors: M901B6-M902B6	MA001L05	0.5m(1.64ft)
	MA001L1	1m(3.28ft)
	MA001L2	2m(6.56ft)
	MA001L3	3m(9.84ft)
	MA001L5	5m(16.40ft)
	MA001L6	6m(19.69ft)
	MA001L10	10m(32.81ft)
	MA001L15	15m(49.23ft)
MA001L20	20m(65.62ft)	

MA005

3P XLR female-3P XLR male



Description	Order Code	Length
High performance prebalanced microphone cable with GST GEAR connectors: M903B6-M904B6	MA005L05	0.5m(1.64ft)
	MA005L1	1m(3.28ft)
	MA005L2	2m(6.56ft)
	MA005L3	3m(9.84ft)
	MA005L5	5m(16.40ft)
	MA005L6	6m(19.69ft)
	MA005L10	10m(32.81ft)
	MA005L15	15m(49.23ft)
MA005L20	20m(65.62ft)	

MA002

3P XLR female-3P XLR male



Description	Order Code	Length
High performance prebalanced microphone cable with GST GEAR connectors: M901-M902	MA002L05	0.5m(1.64ft)
	MA002L1	1m(3.28ft)
	MA002L2	2m(6.56ft)
	MA002L3	3m(9.84ft)
	MA002L5	5m(16.40ft)
	MA002L6	6m(19.69ft)
	MA002L10	10m(32.81ft)
	MA002L15	15m(49.23ft)
MA002L20	20m(65.62ft)	

MA006

3P XLR female-3P XLR male



Description	Order Code	Length
High performance prebalanced microphone cable with GST GEAR connectors: M903-M904	MA006L05	0.5m(1.64ft)
	MA006L1	1m(3.28ft)
	MA006L2	2m(6.56ft)
	MA006L3	3m(9.84ft)
	MA006L5	5m(16.40ft)
	MA006L6	6m(19.69ft)
	MA006L10	10m(32.81ft)
	MA006L15	15m(49.23ft)
MA006L20	20m(65.62ft)	

MA003

3P XLR female-3P XLR male



Description	Order Code	Length
High performance prebalanced microphone cable with GST GEAR connectors: T901B6-T902B6	MA003L05	0.5m(1.64ft)
	MA003L1	1m(3.28ft)
	MA003L2	2m(6.56ft)
	MA003L3	3m(9.84ft)
	MA003L5	5m(16.40ft)
	MA003L6	6m(19.69ft)
	MA003L10	10m(32.81ft)
	MA003L15	15m(49.23ft)
MA003L20	20m(65.62ft)	

MA007

3P XLR female-3P XLR male



Description	Order Code	Length
High performance prebalanced microphone cable with GST GEAR connectors: T903B6-T904B6	MA007L05	0.5m(1.64ft)
	MA007L1	1m(3.28ft)
	MA007L2	2m(6.56ft)
	MA007L3	3m(9.84ft)
	MA007L5	5m(16.40ft)
	MA007L6	6m(19.69ft)
	MA007L10	10m(32.81ft)
	MA007L15	15m(49.23ft)
MA007L20	20m(65.62ft)	

MA0004

3P XLR female-3P XLR male



Description	Order Code	Length
High performance prebalanced microphone cable with GST GEAR connectors: T901-T902	MA004L05	0.5m(1.64ft)
	MA004L1	1m(3.28ft)
	MA004L2	2m(6.56ft)
	MA004L3	3m(9.84ft)
	MA004L5	5m(16.40ft)
	MA004L6	6m(19.69ft)
	MA004L10	10m(32.81ft)
	MA004L15	15m(49.23ft)
MA004L20	20m(65.62ft)	

MA008

3P XLR female-3P XLR male



Description	Order Code	Length
High performance prebalanced microphone cable with GST GEAR connectors: T903-T904	MA008L05	0.5m(1.64ft)
	MA008L1	1m(3.28ft)
	MA008L2	2m(6.56ft)
	MA008L3	3m(9.84ft)
	MA008L5	5m(16.40ft)
	MA008L6	6m(19.69ft)
	MA008L10	10m(32.81ft)
	MA008L15	15m(49.23ft)
MA008L20	20m(65.62ft)	

MA009

3P XLR female-3P XLR male



Description	Order Code	Length
High performance premadebalanced microphone cable with GST GEAR connectors: T9318G-T9328G	MA009L05	0.5m(1.64ft)
	MA009L1	1m(3.28ft)
	MA009L2	2m(6.56ft)
	MA009L3	3m(9.84ft)
	MA009L5	5m(16.40ft)
	MA009L6	6m(19.69ft)
	MA009L10	10m(32.81ft)
	MA009L15	15m(49.21ft)
MA009L20	20m(65.62ft)	

MA013

6.35mm stereo Jack plug-3P XLR male



Description	Order Code	Length
High performance premadebalanced microphone cable with GST GEAR connectors: M9038G-M9048G	MA013L1	1m(3.28ft)
	MA013L3	3m(9.84ft)
	MA013L5	5m(16.40ft)
	MA013L6	6m(19.69ft)
	MA013L10	10m(32.81ft)
	MA013L15	15m(49.21ft)

MA010

3P XLR female-3P XLR male



Description	Order Code	Length
High performance premadebalanced microphone cable with GST GEAR connectors: T993-T994	MA010L05	0.5m(1.64ft)
	MA010L1	1m(3.28ft)
	MA010L2	2m(6.56ft)
	MA010L3	3m(9.84ft)
	MA010L5	5m(16.40ft)
	MA010L6	6m(19.69ft)
	MA010L10	10m(32.81ft)
	MA010L15	15m(49.21ft)
MA010L20	20m(65.62ft)	

MA014

6.35mm stereo Jack plug-3P XLR female



Description	Order Code	Length
High performance premadebalanced microphone cable with GST GEAR connectors: M902-M902	MA014L1	1m(3.28ft)
	MA014L3	3m(9.84ft)
	MA014L5	5m(16.40ft)
	MA014L6	6m(19.69ft)
	MA014L10	10m(32.81ft)
	MA014L15	15m(49.21ft)

MA011

6.35mm mono Jack plug-3P XLR male



Description	Order Code	Length
High performance premadeunbalanced microphone cable with GST GEAR connectors: M901-T901	MA011L1	1m(3.28ft)
	MA011L3	3m(9.84ft)
	MA011L5	5m(16.40ft)
	MA011L6	6m(19.69ft)
	MA011L10	10m(32.81ft)
	MA011L15	15m(49.21ft)

MA015

6.35mm mono Jack plug-3P XLR female



Description	Order Code	Length
High performance premadeunbalanced microphone cable with GST GEAR connectors: M903-T903	MA015L1	1m(3.28ft)
	MA015L3	3m(9.84ft)
	MA015L5	5m(16.40ft)
	MA015L6	6m(19.69ft)
	MA015L10	10m(32.81ft)
	MA015L15	15m(49.21ft)

MA012

6.35mm mono Jack plug-3P XLR female



Description	Order Code	Length
High performance premadeunbalanced microphone cable with GST GEAR connectors: M902-T902	MA012L1	1m(3.28ft)
	MA012L3	3m(9.84ft)
	MA012L5	5m(16.40ft)
	MA012L6	6m(19.69ft)
	MA012L10	10m(32.81ft)
	MA012L15	15m(49.21ft)

MA016

6.35mm mono Jack plug-3P XLR female



Description	Order Code	Length
High performance premadeunbalanced microphone cable with GST GEAR connectors: T904-T904	MA016L1	1m(3.28ft)
	MA016L3	3m(9.84ft)
	MA016L5	5m(16.40ft)
	MA016L6	6m(19.69ft)
	MA016L10	10m(32.81ft)
	MA016L15	15m(49.21ft)



MA017

6.35mm stereo Jack plug-3P XLR male

Description	Order Code	Length
High performance prebalanced microphone cable with GST GEAR connectors: M903-T811	MA0711	1m(3.28ft)
	MA0713	3m(9.84ft)
	MA0715	5m(16.40ft)
	MA0716	6m(19.69ft)
	MA07110	10m(32.81ft)
	MA07115	15m(49.21ft)



MA021

6.35mm right angle mono Jack plug - 6.35mm right angle mono Jack plug

Description	Order Code	Length
High performance preadeguitar cable with GST GEAR connectors: T808BG-T808BG	MA0211	1m(3.28ft)
	MA0213	3m(9.84ft)
	MA0215	5m(16.40ft)
	MA0216	6m(19.69ft)
	MA02110	10m(32.81ft)
	MA02115	15m(49.21ft)

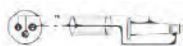

MA018

6.35mm stereo Jack plug-3P XLR female

Description	Order Code	Length
High performance prebalanced microphone cable with GST GEAR connectors: M904-T811	MA0811	1m(3.28ft)
	MA0813	3m(9.84ft)
	MA0815	5m(16.40ft)
	MA0816	6m(19.69ft)
	MA08110	10m(32.81ft)
	MA08115	15m(49.21ft)



MA022

6.35mm stereo Jack plug- 6.35mm stereo Jack plug

Description	Order Code	Length
High performance preadeguitar cable with GST GEAR connectors: T810BG-T810BG	MA0221	1m(3.28ft)
	MA0223	3m(9.84ft)
	MA0225	5m(16.40ft)
	MA02216	6m(19.69ft)
	MA02210	10m(32.81ft)
	MA02215	15m(49.21ft)



MA019

6.35mm mono Jack plug - 6.35mm mono Jack plug

Description	Order Code	Length
High performance preadeguitar cable with GST GEAR connectors: T801	MA0181	1m(3.28ft)
	MA0183	3m(9.84ft)
	MA0185	5m(16.40ft)
	MA0186	6m(19.69ft)
	MA01810	10m(32.81ft)
	MA01815	15m(49.21ft)



MA023

6.35mm mono Jack plug - 6.35mm mono Jack plug

Description	Order Code	Length
High performance preadeguitar cable with GST GEAR connectors: T803-T803	MA0231	1m(3.28ft)
	MA0233	3m(9.84ft)
	MA0235	5m(16.40ft)
	MA0236	6m(19.69ft)
	MA02310	10m(32.81ft)
	MA02315	15m(49.21ft)



MA020

6.35mm right angle mono Jack plug - 6.35mm mono Jack

Description	Order Code	Length
High performance preadeguitar cable with GST GEAR connectors: T810-T808BG	MA0181	1m(3.28ft)
	MA0183	3m(9.84ft)
	MA0185	5m(16.40ft)
	MA0186	6m(19.69ft)
	MA01810	10m(32.81ft)
	MA01815	15m(49.21ft)



MA024

6.35mm mono Jack plug - 6.35mm mono Jack plug

Description	Order Code	Length
High performance prebalanced microphone cable with GST GEAR connectors: T11BG-T811BG	MA0241	1m(3.28ft)
	MA0243	3m(9.84ft)
	MA0245	5m(16.40ft)
	MA0246	6m(19.69ft)
	MA02410	10m(32.81ft)
	MA02415	15m(49.21ft)





MA025

6.35mm mono Jack plug - 6.35mm mono Jack plug



Description	Order Code	Length
High performance prebalanced microphone cable with GST GEAR connectors: T801-T801	MA025L1	1m(3.28ft)
	MA025L3	3m(9.84ft)
	MA025L5	5m(16.40ft)
	MA025L6	6m(19.69ft)
	MA025L10	10m(32.81ft)
	MA025L15	15m(49.21ft)

MA029

6.35mm stereo Jack plug - 6.35mm stereo Jack plug



Description	Order Code	Length
High performance prebalanced microphone cable with GST GEAR connectors: T802-T802	MA029L1	1m(3.28ft)
	MA029L3	3m(9.84ft)
	MA029L5	5m(16.40ft)
	MA029L6	6m(19.69ft)
	MA029L10	10m(32.81ft)
	MA029L15	15m(49.21ft)

MA026

6.35mm stereo Jack plug - 6.35mm stereo Jack plug



Description	Order Code	Length
High performance prebalanced microphone cable with GST GEAR connectors: T811-T811	MA026L1	1m(3.28ft)
	MA026L3	3m(9.84ft)
	MA026L5	5m(16.40ft)
	MA026L6	6m(19.69ft)
	MA026L10	10m(32.81ft)
	MA026L15	15m(49.21ft)

MA030

6.35mm mono Jack plug - 6.35mm mono Jack plug



Description	Order Code	Length
High performance prebalanced cable with GST GEAR connectors: T851-T851	MA030L1	1m(3.28ft)
	MA030L3	3m(9.84ft)
	MA030L5	5m(16.40ft)
	MA030L6	6m(19.69ft)
	MA030L10	10m(32.81ft)
	MA030L15	15m(49.21ft)

MA027

6.35mm right angle mono Jack plug - 6.35mm stereo Jack plug



Description	Order Code	Length
High performance prebalanced cable with GST GEAR connectors: T809-T810	MA027L1	1m(3.28ft)
	MA027L3	3m(9.84ft)
	MA027L5	5m(16.40ft)
	MA027L6	6m(19.69ft)
	MA027L10	10m(32.81ft)
	MA027L15	15m(49.21ft)

MA031

6.35mm mono Jack plug - 6.35mm mono Jack plug



Description	Order Code	Length
High performance prebalanced cable with GST GEAR connectors: T853-T853	MA031L1	1m(3.28ft)
	MA031L3	3m(9.84ft)
	MA031L5	5m(16.40ft)
	MA031L6	6m(19.69ft)
	MA031L10	10m(32.81ft)
	MA031L15	15m(49.21ft)

MA028

6.35mm right angle mono Jack plug - 6.35mm right angle mono Jack plug



Description	Order Code	Length
High performance prebalanced cable with GST GEAR connectors: T809-T809	MA028L1	1m(3.28ft)
	MA028L3	3m(9.84ft)
	MA028L5	5m(16.40ft)
	MA028L6	6m(19.69ft)
	MA028L10	10m(32.81ft)
	MA028L15	15m(49.21ft)

MA032

Speaker connector 4 pole female - Speaker connector 4 pole female



Description	Order Code	Length
High performance prebalanced cable with GST GEAR connectors: T306	MA032L2	2m(6.56ft)
	MA032L3	3m(9.84ft)
	MA032L5	6m(19.69ft)
	MA032L10	10m(32.81ft)
	MA032L15	15m(49.21ft)
	MA032L20	20m(65.62ft)



MA033

Speaker connectr-4 pole female - Speaker connectr 4 pole female

Description	Order Code	Length
High performance pre-mades speaker cable with GST GEAR connectors: T301L	MA033L1	1m(3.28ft)
	MA033L2	2m(6.56ft)
	MA033L3	3m(9.84ft)
	MA033L5	5m(16.40ft)
	MA033L10	10m(32.8ft)
	MA033L15	15m(49.2ft)
MA033L20	20m(65.6ft)	



MA038

Speaker connectr-4 pole female - 6.35mm mono Jack plug

Description	Order Code	Length
High performance pre-mades speaker cable with GST GEAR connectors: T302-T810	MA038L2	2m(6.56ft)
	MA038L3	3m(9.84ft)
	MA038L5	5m(16.40ft)
	MA038L10	10m(32.8ft)
	MA038L15	15m(49.2ft)



MA034

Speaker connectr-4 pole female - 6.35mm mono Jack plug

Description	Order Code	Length
High performance pre-mades speaker cable with GST GEAR connectors: T301L-T805	MA034L2	2m(6.56ft)
	MA034L3	3m(9.84ft)
	MA034L5	5m(16.40ft)
	MA034L10	10m(32.8ft)
	MA034L15	15m(49.2ft)



MA039

Speaker connectr 4 pole female - Speaker connectr 4 pole female

Description	Order Code	Length
High performance pre-mades speaker cable with GST GEAR connectors: T302-T303	MA039L1	1m(3.28ft)
	MA039L2	2m(6.56ft)
	MA039L3	3m(9.84ft)
	MA039L5	5m(16.40ft)
	MA039L10	10m(32.8ft)
	MA039L15	15m(49.2ft)
	MA039L20	20m(65.6ft)



MA035

Speaker connectr-4 pole female - 6.35mm mono Jack plug

Description	Order Code	Length
High performance pre-mades speaker cable with GST GEAR connectors: T301L-T810	MA035L2	2m(6.56ft)
	MA035L3	3m(9.84ft)
	MA035L5	5m(16.40ft)
	MA035L10	10m(32.8ft)
	MA035L15	15m(49.2ft)
	MA035L20	20m(65.6ft)



MA040

Speaker connectr 4 pole female - Speaker connectr 4 pole female

Description	Order Code	Length
High performance pre-mades speaker cable with GST GEAR connectors: T302-T321	MA040L1	1m(3.28ft)
	MA040L2	2m(6.56ft)
	MA040L3	3m(9.84ft)
	MA040L5	5m(16.40ft)
	MA040L10	10m(32.8ft)
	MA040L15	15m(49.2ft)
	MA040L20	20m(65.6ft)



MA036

Speaker connectr 4 pole female - Speaker connectr 4 pole female

Description	Order Code	Length
High performance pre-mades speaker cable with GST GEAR connectors: T302-T302	MA036L1	1m(3.28ft)
	MA036L2	2m(6.56ft)
	MA036L3	3m(9.84ft)
	MA036L5	5m(16.40ft)
	MA036L10	10m(32.8ft)
	MA036L15	15m(49.2ft)
	MA036L20	20m(65.6ft)



MA041

Speaker connectr 4 pole female - 3P XLR male

Description	Order Code	Length
High performance pre-mades speaker cable with GST GEAR connectors: T302-M501	MA041L3	3m(9.84ft)



MA042

Speaker connector 4 pole female - 3P XLR female

Description	Order Code	Length
High performance premade speaker cable with GST GEAR connectors: T303-M302	MA042L03	0.3m(0.98ft)



MA046

Speaker connector-4 pole female - 6.35mm mono Jack plug

Description	Order Code	Length
High performance premade speaker cable with GST GEAR connectors: T304-T810	MA046L2	2m(6.56ft)
	MA046L3	3m(9.84ft)
	MA046L5	5m(16.40ft)
	MA046L10	10m(32.81ft)



MA043

Speaker connector-4 pole female - 6.35mm mono Jack plug

Description	Order Code	Length
High performance premade speaker cable with GST GEAR connectors: T303-T805	MA043L2	2m(6.56ft)
	MA043L3	3m(9.84ft)
	MA043L5	5m(16.40ft)
	MA043L10	10m(32.81ft)



MA047

Speaker connector-4 pole female - 6.35mm mono Jack plug

Description	Order Code	Length
High performance premade speaker cable with GST GEAR connectors: T304-T805	MA047L2	2m(6.56ft)
	MA047L3	3m(9.84ft)
	MA047L5	5m(16.40ft)
	MA047L10	10m(32.81ft)



MA044

Speaker connector-4 pole female - 6.35mm mono Jack plug

Description	Order Code	Length
High performance premade speaker cable with GST GEAR connectors: T303-T805	MA044L2	2m(6.56ft)
	MA044L3	3m(9.84ft)
	MA044L5	5m(16.40ft)
	MA044L10	10m(32.81ft)



MA048

Speaker connector 4 pole female - Speaker connector 4 pole female

Description	Order Code	Length
High performance premade speaker cable with GST GEAR connectors: T305-T305	MA048L1	1m(3.28ft)
	MA048L2	2m(6.56ft)
	MA048L3	3m(9.84ft)
	MA048L5	5m(16.40ft)
	MA048L10	10m(32.81ft)
	MA048L15	15m(49.21ft)
MA048L20	20m(65.62ft)	



MA045

Speaker connector 4 pole female - Speaker connector 4 pole female

Description	Order Code	Length
High performance premade speaker cable with GST GEAR connectors: T304-T304	MA045L1	1m(3.28ft)
	MA045L2	2m(6.56ft)
	MA045L3	3m(9.84ft)
	MA045L5	5m(16.40ft)
	MA045L10	10m(32.81ft)
	MA045L15	15m(49.21ft)
MA045L20	20m(65.62ft)	



MA049

3.5mm stereo Jack plug - 3.5mm stereo Jack plug

Description	Order Code	Length
High performance premade audio connection cable with GST GEAR connectors: T823-T823	MA049L09	0.9m(2.95ft)
	MA049L15	1.5m(4.92ft)
	MA049L3	3m(9.84ft)

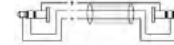



MA050

3.5mm stereo Jack plug - 3.5mm stereo female socket

Description	Order Code	Length
High performance pre-made balanced microphone cable with GST GEAR connectors: T821-T825	MA050L09	0.9m(2.95ft)
	MA050L15	1.5m(4.92ft)
	MA050L3	3m(9.84ft)



MA054

3.5mm stereo Jack plug - XLR 3-pole female plug

Description	Order Code	Length
Performance pre-made balanced audio connection cable with GST GEAR connectors: M904-T821	MA054L09	0.9m(2.95ft)
	MA054L15	1.5m(4.92ft)
	MA054L3	3m(9.84ft)



MA051

3.5mm stereo Jack plug - XLR 3-pole male plug

Description	Order Code	Length
Performance pre-made balanced audio connection cable with GST GEAR connectors: M901-M821	MA051L09	0.9m(2.95ft)
	MA051L15	1.5m(4.92ft)
	MA051L3	3m(9.84ft)



MA055

3.5mm stereo Jack plug - XLR 3-pole male plug

Description	Order Code	Length
Performance pre-made balanced audio connection cable with GST GEAR connectors: M901BG-T822	MA055L09	0.9m(2.95ft)
	MA055L15	1.5m(4.92ft)
	MA055L3	3m(9.84ft)



MA052

3.5mm stereo Jack plug - XLR 3-pole female plug

Description	Order Code	Length
Performance pre-made balanced audio connection cable with GST GEAR connectors: M902-T821	MA052L09	0.9m(2.95ft)
	MA052L15	1.5m(4.92ft)
	MA052L3	3m(9.84ft)



MA056

3.5mm stereo Jack plug - XLR 3-pole female plug

Description	Order Code	Length
Performance pre-made balanced audio connection cable with GST GEAR connectors: T9038G-T822	MA056L09	0.9m(2.95ft)
	MA056L15	1.5m(4.92ft)
	MA056L3	3m(9.84ft)



MA053

3.5mm stereo Jack plug - XLR 3-pole male plug

Description	Order Code	Length
Performance pre-made balanced audio connection cable with GST GEAR connectors: M903-T821	MA053L09	0.9m(2.95ft)
	MA053L15	1.5m(4.92ft)
	MA053L3	3m(9.84ft)



MA057

3.5mm stereo Jack plug - XLR 3-pole female plug

Description	Order Code	Length
Performance pre-made balanced audio connection cable with GST GEAR connectors: M903BG-T822	MA057L09	0.9m(2.95ft)
	MA057L15	1.5m(4.92ft)
	MA057L3	3m(9.84ft)



MA058

3.5mm stereo Jack plug - XLR 3-pole female plug

Description	Order Code	Length
High performance pre made balanced audio connection cable with GST GEAR connectors: M9048G-T822	MA058L09	0.9m(2.95ft)
	MA058L15	1.5m(4.92ft)
	MA058L3	3m(9.84ft)



MA062

3.5mm stereo Jack plug - 3.5mm stereo female socket

Description	Order Code	Length
High performance pre made balanced microphone cable with GST GEAR connectors: T8238G-T825	MA062L2	2m(6.56ft)
	MA062L3	3m(9.84ft)
	MA062L6	6m(19.69ft)
	MA062L9	9m(29.53ft)

MA059

3.5mm stereo Jack plug - 3.5mm stereo female socket

Description	Order Code	Length
High performance pre made balanced microphone cable with GST GEAR connectors: T822-T825	MA059L2	2m(6.56ft)
	MA059L3	3m(9.84ft)
	MA059L6	6m(19.69ft)
	MA059L9	9m(29.53ft)

MA063

3.5mm stereo Jack plug - XLR 3-pole male plug

Description	Order Code	Length
High performance pre made balanced audio connection cable with GST GEAR connectors: M9018G-T238G	MA063L09	0.9m(2.95ft)
	MA063L15	1.5m(4.92ft)
	MA063L3	3m(9.84ft)



MA060

3.5mm stereo Jack plug - 3.5mm stereo Jack socket

Description	Order Code	Length
High performance pre made audio connection cable with GST GEAR connectors: T822-T823	MA060L09	0.9m(2.95ft)
	MA060L15	1.5m(4.92ft)
	MA060L3	3m(9.84ft)

MA064

3.5mm stereo Jack plug - XLR 3-pole female plug

Description	Order Code	Length
High performance pre made balanced audio connection cable with GST GEAR connectors: M9028G-T8238G	MA064L09	0.9m(2.95ft)
	MA064L15	1.5m(4.92ft)
	MA064L3	3m(9.84ft)



MA061

3.5mm stereo Jack plug - 3.5mm stereo Jack socket

Description	Order Code	Length
High performance pre made audio connection cable with GST GEAR connectors: T8238G-T8238G	MA061L09	0.9m(2.95ft)
	MA061L15	1.5m(4.92ft)
	MA061L3	3m(9.84ft)

MA065

3.5mm stereo Jack plug - XLR 3-pole female plug

Description	Order Code	Length
High performance pre made balanced audio connection cable with GST GEAR connectors: M9038G-T8238G	MA065L09	0.9m(2.95ft)
	MA065L15	1.5m(4.92ft)
	MA065L3	3m(9.84ft)





MA066

3.5mm stereo Jack plug - XLR 3-pole female plug

Description	Order Code	Length
Performance pre-made balanced audio connection cable with GST GEAR connectors: M904BG-T823BG	MA066L09	0.9m(3.29ft)
	MA066L15	1.5m(4.92ft)
	MA066L3	3m(9.84ft)



MA070

RCA plug - XLR male plug

Description	Order Code	Length
High performance pre-made audio connection cable with GST GEAR connectors: M902BG-T605	MA070L1	1m(3.28ft)
	MA070L15	1.5m(4.92ft)
	MA070L2	2m(6.56ft)
	MA070L3	3m(9.84ft)
	MA070L5	5m(16.40ft)
	MA070L6	6m(19.69ft)

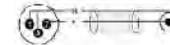

MA067

RCA plug - RCA plug

Description	Order Code	Length
High performance pre-made audio connection cable with GST GEAR connectors: T605-T605	MA067L1	1m(3.28ft)
	MA067L15	1.5m(4.92ft)
	MA067L2	2m(6.56ft)
	MA067L3	3m(9.84ft)
	MA067L5	5m(16.40ft)
	MA067L6	6m(19.69ft)



MA071

RCA plug - XLR female plug

Description	Order Code	Length
High performance pre-made audio connection cable with GST GEAR connectors: M902BG-T605	MA071L1	1m(3.28ft)
	MA071L15	1.5m(4.92ft)
	MA071L2	2m(6.56ft)
	MA071L3	3m(9.84ft)
	MA071L5	5m(16.40ft)
	MA071L6	6m(19.69ft)

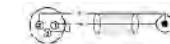

MA068

RCA plug - RCA plug

Description	Order Code	Length
High performance pre-made audio connection cable with GST GEAR connectors: T605-T607	MA068L1	1m(3.28ft)
	MA068L15	1.5m(4.92ft)
	MA068L2	2m(6.56ft)
	MA068L3	3m(9.84ft)
	MA068L5	5m(16.40ft)
	MA068L6	6m(19.69ft)



MA072

RCA plug - XLR male plug

Description	Order Code	Length
High performance pre-made audio connection cable with GST GEAR connectors: M903BG-T605	MA072L1	1m(3.28ft)
	MA072L15	1.5m(4.92ft)
	MA072L2	2m(6.56ft)
	MA072L3	3m(9.84ft)
	MA072L5	5m(16.40ft)
	MA072L6	6m(19.69ft)



MA069

6.35mm mono Jack plug - RCA plug

Description	Order Code	Length
High performance pre-made balanced microphone cable with GST GEAR connectors: T605-T810	MA069L1	1m(3.28ft)
	MA069L15	1.5m(4.92ft)
	MA069L2	2m(6.56ft)
	MA069L3	3m(9.84ft)



MA073

RCA plug - XLR female plug

Description	Order Code	Length
High performance pre-made audio connection cable with GST GEAR connectors: M904BG-T605	MA073L1	1m(3.28ft)
	MA073L15	1.5m(4.92ft)
	MA073L2	2m(6.56ft)
	MA073L3	3m(9.84ft)
	MA073L5	5m(16.40ft)
	MA073L6	6m(19.69ft)





MA201

2 x 6.35mm stereo Jack plug - 2 x 6.35mm stereo Jack plug

Description	Order Code	Length
Professional pre made balanced audio connection cable with GST GEAR molded connectors	MA201L09	0.9m(2.95ft)
	MA201L15	1.5m(4.92ft)
	MA201L3	3m(9.84ft)
	MA201L5	5m(16.40ft)
	MA201L10	10m(32.81ft)



MA205

2 x 6.35mm mono Jack plug - 2 x 6.35mm mono right angle Jack plug

Description	Order Code	Length
Professional pre made unbalanced audio connection cable with GST GEAR molded connectors	MA205L09	0.9m(2.95ft)
	MA205L1	1m(3.28ft)
	MA205L15	1.5m(4.92ft)
	MA205L2	2m(6.56ft)
	MA205L3	3m(9.84ft)
	MA205L6	6m(19.69ft)



MA202

2 x 6.35mm mono Jack plug - 2 x 6.35mm mono right angle Jack plug

Description	Order Code	Length
Professional pre made unbalanced audio connection cable with GST GEAR molded connectors	MA202L09	0.9m(2.95ft)
	MA202L15	1.5m(4.92ft)
	MA202L3	3m(9.84ft)
	MA202L5	5m(16.40ft)
	MA202L10	10m(32.81ft)



MA206

2 x 6.35mm mono Jack plug - 2 x 6.35mm mono right angle Jack plug

Description	Order Code	Length
Professional pre made unbalanced audio connection cable with GST GEAR molded connectors	MA206L09	0.9m(2.95ft)
	MA206L1	1m(3.28ft)
	MA206L15	1.5m(4.92ft)
	MA206L2	2m(6.56ft)
	MA206L3	3m(9.84ft)
	MA206L6	6m(19.69ft)



MA203

2 x 6.35mm mono Jack plug - 2 x 6.35mm mono right angle Jack plug

Description	Order Code	Length
Professional pre made unbalanced audio connection cable with GST GEAR molded connectors	MA203L09	0.9m(2.95ft)
	MA203L15	1.5m(4.92ft)
	MA203L3	3m(9.84ft)
	MA203L5	5m(16.40ft)
	MA203L10	10m(32.81ft)



MA207

2 x RCA plug - 2 x RCA plug

Description	Order Code	Length
Professional pre made unbalanced audio connection cable with GST GEAR molded connectors	MA207L1	1m(3.28ft)
	MA207L2	2m(6.56ft)
	MA207L3	3m(9.84ft)
	MA207L6	6m(19.69ft)



MA204

2 x 6.35mm stereo Jack plug - 2 x 6.35mm stereo Jack plug

Description	Order Code	Length
Professional pre made unbalanced audio connection cable with GST GEAR molded connectors	MA204L09	0.9m(2.95ft)
	MA204L1	1m(3.28ft)
	MA204L15	1.5m(4.92ft)
	MA204L2	2m(6.56ft)
	MA204L3	3m(9.84ft)
	MA204L6	6m(19.69ft)



MA208

2 x RCA plug - 2 x RCA female socket

Description	Order Code	Length
Professional pre made unbalanced audio connection cable with GST GEAR molded connectors	MA208L09	0.9m(2.95ft)
	MA208L15	1.5m(4.92ft)
	MA208L3	3m(9.84ft)
	MA208L5	5m(16.40ft)
	MA208L10	10m(32.81ft)
	MA208L15	15m(49.21ft)



MA301

1 x XLR 3-pole male plug - 2 x XLR 3-pole female plug

Description	Order Code	Length
High performance pre-made audio connection cable with GST GEAR connectors	MA301L1	1mt(3.28ft)
	MA301L2	2mt(6.56ft)
	MA301L3	3mt(9.84ft)
	MA301L6	6mt(19.69ft)



MA305

1 x 3.5mm stereo Jack plug - 2 x XLR 3-pole female plug

Description	Order Code	Length
High performance pre-made audio connection cable with GST GEAR connectors	MA305L1	1mt(3.28ft)
	MA305L2	2mt(6.56ft)
	MA305L3	3mt(9.84ft)



MA302

1 x XLR 3-pole male plug - 2 x XLR 3-pole female plug

Description	Order Code	Length
High performance pre-made audio connection cable with GST GEAR connectors	MA302L1	1mt(3.28ft)
	MA302L2	2mt(6.56ft)
	MA302L3	3mt(9.84ft)
	MA302L6	6mt(19.69ft)



MA306

1 x 3.5mm stereo Jack plug - 2 x XLR 3-pole female plug

Description	Order Code	Length
High performance pre-made audio connection cable with GST GEAR connectors	MA306L1	1mt(3.28ft)
	MA306L2	2mt(6.56ft)
	MA306L3	3mt(9.84ft)



MA303

1 x 3.5mm stereo Jack plug - 2 x XLR 3-pole male plug

Description	Order Code	Length
High performance pre-made audio connection cable with GST GEAR connectors	MA303L1	1mt(3.28ft)
	MA303L2	2mt(6.56ft)
	MA303L3	3mt(9.84ft)



M307

1 x 3.5mm stereo Jack plug - 2 x RCA plug

Description	Order Code	Length
High performance pre-made audio connection cable with GST GEAR connectors	MA307L1	1mt(3.28ft)
	MA307L2	2mt(6.56ft)
	MA307L3	3mt(9.84ft)
	MA307L6	6mt(19.69ft)



MA304

1 x 3.5mm stereo Jack plug - 2 x XLR 3-pole female plug

Description	Order Code	Length
High performance pre-made audio connection cable with GST GEAR connectors	MA304L1	1mt(3.28ft)
	MA304L2	2mt(6.56ft)
	MA304L3	3mt(9.84ft)



MA308

1 x 3.5mm stereo Jack plug - 2 x 3.5mm stereo female socket

Description	Order Code	Length
High performance pre-made audio connection cable with GST GEAR connectors	MA308L02	0.2mt(0.66ft)



MA309

1 x 3.5mm stereo Jack plug - 2 x RCA plug

Description	Order Code	Length
High performance pre-made audio connection cable with GST GEAR connectors	MA309L1	1mt(3.28ft)
	MA309L2	2mt(6.56ft)
	MA309L3	3mt(9.84ft)
	MA309L6	6mt(19.69ft)



MA313

1 x 6.35mm stereo Jack plug - 2 x 6.35mm mono Jack plug

Description	Order Code	Length
High performance pre-made audio connection cable with GST GEAR connectors	MA313L1	1mt(3.28ft)
	MA313L5	1.5mt(4.92ft)
	MA313L2	2mt(6.56ft)
	MA313L3	3mt(9.84ft)
	MA313L6	6mt(19.69ft)



MA310

1 x 3.5mm stereo Jack plug - 2 x 6.35mm mono Jack plug

Description	Order Code	Length
High performance pre-made audio connection cable with GST GEAR connectors	MA310L1	1mt(3.28ft)
	MA310L2	2mt(6.56ft)
	MA310L3	3mt(9.84ft)
	MA310L6	6mt(19.69ft)



MA314

1 x 3.5mm stereo Jack plug - 2 x 6.35mm mono Jack plug

Description	Order Code	Length
High performance pre-made audio connection cable with GST GEAR connectors	MA314L1	1mt(3.28ft)
	MA314L5	1.5mt(4.92ft)
	MA314L2	2mt(6.56ft)
	MA314L3	3mt(9.84ft)
	MA314L6	6mt(19.69ft)



MA311

1 x 3.5mm stereo Jack plug - 2 x 6.35mm mono Jack plug

Description	Order Code	Length
High performance pre-made audio connection cable with GST GEAR connectors	MA311L1	1mt(3.28ft)
	MA311L2	2mt(6.56ft)
	MA311L3	3mt(9.84ft)
	MA311L6	6mt(19.69ft)



M315

1 x RCA plug - 2 x RCA female socket

Description	Order Code	Length
High performance pre-made audio connection cable with GST GEAR connectors	MA315L02	0.2mt(0.66ft)



MA312

1 x 6.35mm stereo Jack plug - 2 x 6.35mm mono Jack plug

Description	Order Code	Length
High performance pre-made audio connection cable with GST GEAR connectors	MA312L1	1mt(3.28ft)
	MA312L5	1.5mt(4.92ft)
	MA312L2	2mt(6.56ft)
	MA312L3	3mt(9.84ft)
	MA312L6	6mt(19.69ft)



MA316

1 x RCA female socket - 2 x RCA plug

Description	Order Code	Length
High performance pre-made audio connection cable with GST GEAR connectors	MA316L02	0.2mt(0.66ft)



MA501

1 x molded 3.5mm stereo Jack plug - 2 x molded RCA plug



Description	Order Code	Length
Professional pre made Y-Adapter cable with GST GEAR molded connectors	MA501015	1.5m(4.92ft)
	MA50113	3m(9.84ft)
	MA50115	5m(16.40ft)
	MA50110	10m(32.8ft)
	MA501115	15m(49.2ft)
	MA501120	20m(65.6ft)



MA541

1 x molded 3.5mm stereo Jack plug - 1 x molded 3.5mm stereo female socket

Description	Order Code	Length
Professional pre made balanced audio connection cable with GST GEAR molded connectors	MA541015	1.5m(4.92ft)
	MA54113	3m(9.84ft)
	MA54115	5m(16.40ft)
	MA54115	5m(16.40ft)

MA511

1 x molded 3.5mm stereo Jack plug - 2 x molded 6.35mm mono Jack plug



Description	Order Code	Length
Professional pre made Y-Adapter cable with GST GEAR molded connectors	MA511015	1.5m(4.92ft)
	MA51113	3m(9.84ft)
	MA51115	5m(16.40ft)
	MA51110	10m(32.8ft)
	MA511115	15m(49.2ft)
	MA511120	20m(65.6ft)



MA521

1 x molded 3.5mm stereo Jack plug - 1 x molded 6.35mm stereo Jack plug

Description	Order Code	Length
Professional pre made balanced audio connection cable with GST GEAR molded connectors	MA521015	1.5m(4.92ft)
	MA52113	3m(9.84ft)
	MA52115	5m(16.40ft)

MA551

2 x molded RCA plug - 2 x molded RCA plug



Description	Order Code	Length
Professional pre made balanced audio connection cable with GST GEAR molded connectors	MA551015	1.5m(4.92ft)
	MA55113	3m(9.84ft)
	MA55115	5m(16.40ft)



MA531

1 x molded 3.5mm stereo Jack plug - 1 x molded 3.5mm stereo Jack plug



Description	Order Code	Length
Professional pre made balanced audio connection cable with GST GEAR molded connectors	MA531015	1.5m(4.92ft)
	MA53113	3m(9.84ft)
	MA53115	5m(16.40ft)
	MA53110	10m(32.8ft)
	MA531115	15m(49.2ft)
	MA531120	20m(65.6ft)



MS001

2 x XLR 3-pole female+2 x XLR 3-pole male--2 x XLR 3-pole female+2 x XLR 3-pole male



Order Code	Specification	O.D	Length
M5001-4	4CH XLR(F)TO XLR(M)	10mm	1m-20m (F T)
M5001-6	6CH XLR(F)TO XLR(M)	12mm	
M5001-8	8CH XLR(F)TO XLR(M)	13mm	
M5001-12	12CH XLR(F)TO XLR(M)	15.5mm	

MS005

8 x XLR 3-pole female--8 x 6.35mm stereo Jack plug



Order Code	Specification	O.D	Length
M5005-4	4CH XLR(F)TO XLR(M)	10mm	1m-20m (F T)
M5005-6	6CH XLR(F)TO XLR(M)	12mm	
M5005-8	8CH XLR(F)TO XLR(M)	13mm	
M5005-12	12CH XLR(F)TO XLR(M)	15.5mm	

MS002

4 x XLR 3-pole female-4 x XLR 3-pole male



Order Code	Specification	O.D	Length
M5002-4	4CH XLR(F)TO XLR(M)	10mm	1m-20m (F T)
M5002-6	6CH XLR(F)TO XLR(M)	12mm	
M5002-8	8CH XLR(F)TO XLR(M)	13mm	
M5002-12	12CH XLR(F)TO XLR(M)	15.5mm	

MS006

8 x XLR 3-pole male--8 x 6.35mm stereo Jack plug



Order Code	Specification	O.D	Length
M5006-4	4CH XLR(F)TO XLR(M)	10mm	1m-20m (F T)
M5006-6	6CH XLR(F)TO XLR(M)	12mm	
M5006-8	8CH XLR(F)TO XLR(M)	13mm	
M5006-12	12CH XLR(F)TO XLR(M)	15.5mm	

MS003

8 x XLR 3-pole female--8 x XLR 3-pole male



Order Code	Specification	O.D	Length
M5003-4	4CH XLR(F)TO XLR(M)	10mm	1m-20m (F T)
M5003-6	6CH XLR(F)TO XLR(M)	12mm	
M5003-8	8CH XLR(F)TO XLR(M)	13mm	
M5003-12	12CH XLR(F)TO XLR(M)	15.5mm	

MS007

8 x RCA plug -- 8 x 6.35mm mono. Jack plug



Order Code	Specification	O.D	Length
M5007-4	4CH XLR(F)TO XLR(M)	10mm	1m-20m (F T)
M5007-6	6CH XLR(F)TO XLR(M)	12mm	
M5007-8	8CH XLR(F)TO XLR(M)	13mm	
M5007-12	12CH XLR(F)TO XLR(M)	15.5mm	

MS004

4 x XLR 3-pole female+4 x XLR 3-pole male--4 x XLR 3-pole female+ 4 x XLR 3-pole male



Order Code	Specification	O.D	Length
M5004-4	4CH XLR(F)TO XLR(M)	10mm	1m-20m (F T)
M5004-6	6CH XLR(F)TO XLR(M)	12mm	
M5004-8	8CH XLR(F)TO XLR(M)	13mm	
M5004-12	12CH XLR(F)TO XLR(M)	15.5mm	

MS008

8 x 6.35mm stereo Jack plug -- 8 x 6.35mm stereo Jack plug



Order Code	Specification	O.D	Length
M5008-4	4CH XLR(F)TO XLR(M)	10mm	1m-20m (F T)
M5008-6	6CH XLR(F)TO XLR(M)	12mm	
M5008-8	8CH XLR(F)TO XLR(M)	13mm	
M5008-12	12CH XLR(F)TO XLR(M)	15.5mm	

Empty Cable Drum



Size:

- TCA SIZE(H x W x D): 380mm x 170mm x 213mm
- TCE SIZE(H x W x D): 320mm x 150mm x 172mm

Introduction:

- The frame is made of solid iron with the handle, easier to use, drum is made from a solid iron, with detachable cable feeder.
- Easy for use and transportation.
- Capacity depends on different outer diameter of cables.

Introduction:

- Professional empty cable drum for long length multicore cables; Malt black powder coated steel, 4pcs PU wheels, 2pcs with brake.
- Order Code: TCB-8 TCB-12 TCB-16 TCB-20 TCB-24
- Channel: 8 12 16 20 24

Can be equipped with panel type:



Size:

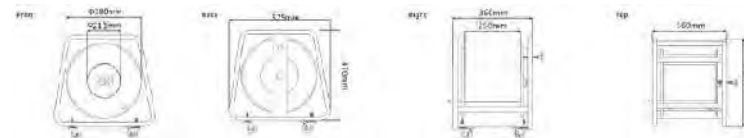

Introduction:

- Professional empty cable drum for long length multicore cables; Mat black powder coated steel, 4pcs PU wheels, 2pcs with brake.
- Order Code: TCC-8 TCC-16 TCC-24 TCC-32 TCC-40
- Channel: 8 16 24 32 40

Size:

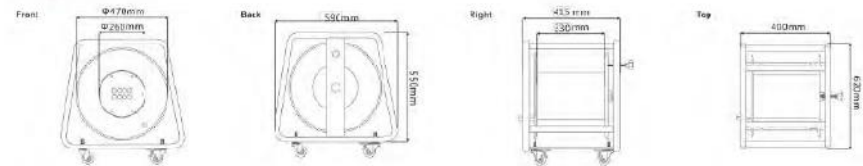

Introduction:

- Professional empty cable drum for long length multicore cables; Malt black powder coated steel, 4pcs PU wheels, 2pcs with brake.
- Order Code: TCD-8 TCD-12 TCD-16 TCD-20 TCD-24
- Channel: 8 12 16 20 24

Size:

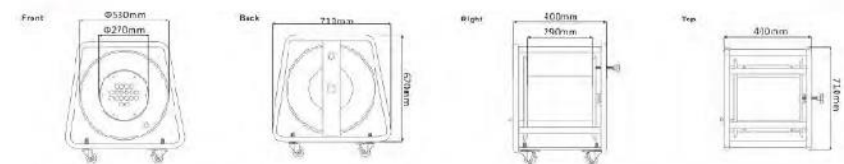

Can be equipped with panel type:

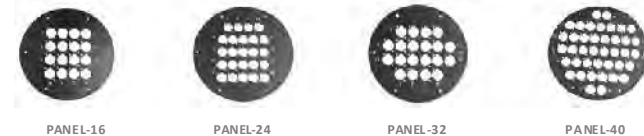

Cable Drum



T903BG T904BG T908BG T907BG

Introduction:

- Professional unbreakable cable drum system, assembled with 8 channels snake cables and GST GEAR connectors.
- Suitable for various of long cables.
- The frame is made of solid iron with the handle, easier to use drum is made from a solid iron .with detachable cable feeder.



T903BG T908BG

Order Code	Channel	Specification	Length
TC4A	4CH	4 xlr male to 4 xlr female	Max: 50m
TC8A	8CH	8 xlr male to 8 xlr female	Max: 50m
TC12A	12CH(8+4)	8 xlr male+4 xlr female to 8 xlr female+4 xlr male	Max: 50m
TC16A	16CH(12+4)	12 xlr male+4 xlr female to 12 xlr female+4 xlr male	Max: 30m

Introduction:

- Professional snake cable with wheels, covered with black and blue heat shrink sleeving.
- Uses GST GEAR Leader series XLR connectors and sockets, with all numbers molded on the XLR code ring, ensuring they remain intact even after long-term use.
- Combinations can reach up to 40 channels.
- Custom-made options are available.
- The frame is a sturdy powder-coated steel rack with detachable cable feeds. Nylon cable separators offer flexibility, bend resistance, and protect cables while increasing tensile strength.
- The numbers displayed on the white tube are clearly visible and resistant to scratches.

Order Code	Channel	Specification	Length
TC16C	16CH(12+4)	12 xlr male+4 xlr female to 12 xlr female+4 xlr male	70m/80m
TC24C	24CH(20+4)	20 xlr male+4 xlr female to 20 xlr female+4 xlr male	50m
TC32C	32CH(24+8)	24 xlr male+8 xlr female to 24 xlr female+8 xlr male	50m
TC40C	40CH(32+8)	32 xlr male+8 xlr female to 32 xlr female+8 xlr male	50m

Cable Drum



Introduction:

- Professional snake cable with wheels, covered with black and red heat shrink sleeving.
- Matte black powder-coated steel, 4 PU wheels, 2 with brakes.
- We will supply different-sized cable drums according to different cable lengths.



Order Code	Channel	Specification	Length
TC8B	8CH(4+4)	4 xlr male+4 xlr female to 4 xlr female+4 xlr male	Max: 50m
TC12B	12CH(8+4)	8 xlr male+4 xlr female to 8 xlr female+4 xlr male	Max: 50m
TC16B	16CH(12+4)	12 xlr male+4 xlr female to 12 xlr female+4 xlr male	Max: 50m
TC20B	20CH(16+4)	16 xlr male+4 xlr female to 16 xlr female+4 xlr male	Max: 50m
TC24B	24CH(20+4)	20 xlr male+4 xlr female to 20 xlr female+4 xlr male	Max: 50m
TC28B	28CH(24+4)	24 xlr male+4 xlr female to 24 xlr female+4 xlr male	Max: 30m

Stage Box

TW1



Introduction:

- This series, built in an epoxy-finished metal box, features small weight and dimensions, thanks to its professional printed circuit.
- High-quality XLR contacts with nylon connectors.
- The nickel-plated steel cable bale and grip securely hold multi-pair cables.



Order Code	Channel	Specification	Length
TW1-6	6	6 xlr male to 6 xlr female	5m/10m/15m/20m
TW1-8	8	8 xlr male to 8 xlr female	25m/30m/40m/50m

Stage Box

TW2



TW3



Introduction:

- This series of stage boxes are made of high-quality aluminum alloy. The snake cable is covered with black and blue heat shrink sleeving, and all the terminal plugs are numbered by silkscreen.
- Professional soldering and assembly technology ensures high-quality signal transmission.
- Custom-made options are available.



Order Code	Channel	Specification	Length
TW2-8	8	4 xlr male+4 xlr female to 4 xlr female+4 xlr male	20m/30m/50m
TW2-12	12	8 xlr male+4 xlr female to 8 xlr female+4 xlr male	20m/30m/50m
TW2-16	16	12 xlr male+4 xlr female to 12 xlr female+4 xlr male	20m/30m/50m
TW2-20	20	16 xlr male+4 xlr female to 16 xlr female+4 xlr male	20m/30m/50m
TW2-24	24	20 xlr male+4 xlr female to 20 xlr female+4 xlr male	20m/30m/50m
TW2-28	28	24 xlr male+4 xlr female to 24 xlr female+4 xlr male	20m/30m/50m
TW2-32	32	28 xlr male+4 xlr female to 28 xlr female+4 xlr male	20m/30m/50m
TW2-36	36	32 xlr male+4 xlr female to 32 xlr female+4 xlr male	20m/30m/50m
TW2-40	40	36 xlr male+4 xlr female to 36 xlr female+4 xlr male	20m/30m/50m
TW2-44	44	40 xlr male+4 xlr female to 40 xlr female+4 xlr male	20m/30m/50m

Introduction:

- This series of stage boxes has a special epoxy-finished metal box. High-quality metal connectors are soldered onto the rear, and the powder coating is smooth. It is a professional metal box with a carry handle, crafted by hand. The trunk is securely connected to the box with strong nylon relief.
- Nylon cable separators provide greater flexibility, bend resistance, protect cables, and enhance tensile strength.
- The numbers displayed on the white tube are clearly visible and resistant to scratches.
- Custom-made options are available.

Order Code	Channel	Specification	Length
TW3-8	8	4 xlr male+4 xlr female to 4 xlr female+4 xlr male	20m/30m/50m
TW3-12	12	8 xlr male+4 xlr female to 8 xlr female+4 xlr male	20m/30m/50m
TW3-16	16	12 xlr male+4 xlr female to 12 xlr female+4 xlr male	20m/30m/50m
TW3-20	20	16 xlr male+4 xlr female to 16 xlr female+4 xlr male	30m/50m
TW3-24	24	20 xlr male+4 xlr female to 20 xlr female+4 xlr male	30m/50m
TW3-28	28	24 xlr male+4 xlr female to 24 xlr female+4 xlr male	30m/50m
TW3-32	32	28 xlr male+4 xlr female to 28 xlr female+4 xlr male	30m/50m
TW3-36	36	32 xlr male+4 xlr female to 32 xlr female+4 xlr male	30m/50m
TW3-40	40	36 xlr male+4 xlr female to 36 xlr female+4 xlr male	30m/50m
TW3-44	44	40 xlr male+4 xlr female to 40 xlr female+4 xlr male	30m/50m

Cable Drum / Assembled With Power Cable



Introduction:

- Professional power cable drum with RVV cable and power connector.
- Maximum power: 6000W; Rated voltage: 250V.
- Line length and special specifications can be customized.

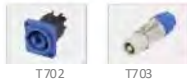

Order Code	Length
PCAL20	20m
PCAL30	30m
PCAL40	40m
PCAL50	50m

Cable drum / Assembled With HDMI Optical Fiber Cable HDMI



Patent Number
201922209121.B

Introduction:

- Professional cable drum with assembled HDMI optical fiber cable.
- Compatible with all devices featuring an HDMI interface, including:
 - DVD players to connect to HDTVs
 - Projectors and HDTVs with HDMI interfaces
 - Computers, PS3 game consoles to connect to HDTVs and projectors, etc.



Order Code	Length
HFCL20	20m
HFCL30	30m
HFCL40	40m
HFCL50	50m

Cable Drum / Assembled With CAT5e Cable



Introduction:

- Professional shockproof network cable drum, assembled with high-flexibility CAT5e data cables and RJ45 connectors.



T201B



T208-1

Order Code	Length
NCAL20/NCBL20	20m
NCAL30/NCBL30	30m
NCA40/NCBL40	40m
NCAL50/NCBL50	50m

2-8 Channel Network Cable Car



Introduction:

- Elastic PVC outer sheath with aluminum foil + copper mesh shielding for each channel. Precise twisting pitch controls crosstalk, reduces attenuation and echo loss, improves electrical performance, and resists external electromagnetic interference, ensuring stable high-speed signal transmission.
- Passed Fluke test, stable crimping, 100% testing, reliable performance.
- Finished network cables are ideal for rental screening.

Order Code	Channel	Length
TC-CAT6-2	2	20M
TC-CAT6-2	2	30M
TC-CAT6-2	2	50M
TC-CAT6-2	2	80M
TC-CAT6-4	4	20M
TC-CAT6-4	4	30M
TC-CAT6-4	4	50M
TC-CAT6-4	4	80M
TC-CAT6-6	6	20M
TC-CAT6-6	6	30M
TC-CAT6-6	6	50M
TC-CAT6-6	6	80M
TC-CAT6-8	8	20M
TC-CAT6-8	8	30M
TC-CAT6-8	8	50M
TC-CAT6-8	8	80M



T201B



T208-1



T210



Snake Cable Accessories



ST8

ST12

ST16

ST20



ST24

ST28

ST32

ST40



L4

4CH

L8

8CH

L16

16CH(1
2+4)



L12

12CH(8+4)

L24

24CH(20+4)

LJT-S Φ 10mm-14mm
LJT-1 Φ 15mm-17mm
LJT-2 Φ 18mm-21mm

LJT-3 Φ 22mm-25mm
LJT-4 Φ 26mm-27mm

LJT-1-A Φ 15mm-17mm
LJT-1-B Φ 18mm-21mm
LJT-1-C Φ 22mm-25mm
LJT-1-D Φ 26mm-27mm

LJT-2-A Φ 15mm-17mm
LJT-2-B Φ 18mm-21mm
LJT-2-C Φ 22mm-25mm
LJT-2-D Φ 26mm-27mm



VGA Cable



J1001

J1002

J1003

J1004

Introduction:

- VGA Male to Male Connection Cable, distortion-free transmission with a 3+6 core structure.
- Connectors are gold-plated, offering anti-oxidation properties and effectively enhancing signal transmission quality.
- Durable even after multiple insertions and removals.
- Equipped with a magnetic ring design to prevent interference from other electronic devices, enhancing EMI/RFI signal isolation and resolving issues like ripples and ghosting.
- Stylish appearance with PVC insulation for both the outer sheath and core, providing flexibility, toughness, and environmental flame retardancy.

	30AWG(Copper cable is single-stranded, with a diameter of 0.25 millimeters.)
	(1/0.25BC-1C+D)+3C+1/0.25BC+6C+AL+D+96B+PVC OD.7.3mm
	(1/0.25BC*1P+D)*3C: Three single strands of 0.25mm pure copper plus one ground cable.
	1/0.25BC*4C: Six single strands
	AL: Aluminum foil Mylar
	D: Overall ground cable
	96B: 96 braided
	PVC: Outer sheath of the cable
1.5M 3M 5M 10M 12M 15M 20M 25M 30M	

HDMI HD Cables



J2001 4K



J2002 4K



J2003 4K



J2004 4K



J2005 4K



J2010-2.1 version 8K



4K certificate



8K certificate"

Version: Standard HDMI2.0

- True 4K, compliant with international HD cable manufacturing standards: Officially certified by HDMI Association members.
- Supports 3D video, Dolby Atmos / DTS:X, and ARC audio return signal.
- Resolutions: Fully compatible with 4K, 2K, 1080P, and other resolutions.
- Color values (YUV/RGB): 4:4:4 / 4:4:2 / 4:4:0, fully supports picture clarity at 60Hz, making it a top choice for gamers with high dynamic resolution and 4K HDR, supporting ultra-high-definition color dynamic contrast.
- HDCP: Supports HDCP 2.2 / HDCP 1.1 backward compatibility.
- Bandwidth transmission: 18Gbps.
- HDMI interfaces: Standard HDMI head + MICRO HDMI head, can pass through a 22mm engineering pipe diameter.
- True gold-plated connectors, highly elastic flame-retardant sheath.
- Passes six durability tests: terminal, wire 10,000 insertion/removal cycles, 25KG weight hanging test, 24-hour salt mist test, and 4K playback test still ensures the product is in good condition.
- Complies with international environmental standards, with multiple certificates for peace of mind: ROHS 2.0 enhanced version certification, ISO 9001:2015 certification.

HDMI 2.0 version

J2001



J2002



Introduction:

- 100% fully digital, no compression, no video conversion.
- The wire core uses 28AWG high-quality oxygen-free copper, with a standard 19+1 core structure.
- HDMI 2.0 / 2.1 version, supports 3D playback, supports 4K/2K resolution at 18Gbps, 3840x2160p. Suitable for video signal cable conversion between computers, Blu-ray DVDs, digital TVs, projectors, etc., enabling easy conversion between DVI, DP interfaces, and HDMI interfaces.
- Supports Ethernet channels for synchronous searching or downloading, with audio feedback channels, high-speed bidirectional communication, direct transmission of TV audio to the A/V amplifier, and automatic audio and video sync processing.
- Supports expanded color space, perfectly rendering professional digital camera quality.

HDMI Cable Testing Steps

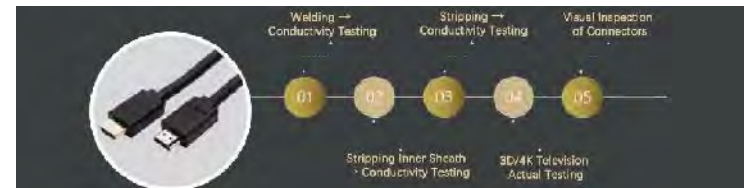

J2001

- molded HDM 19pin male to male cable.
- Length 1/2/3/4/5/7/8/10/15/20m.
- HDMI 2.0 version 4Kx2K 18Gbps HDMI

J2002

- molded HDMI19pin male to male cable, dual color.
- Length: 1/2/3/4/5/7/8/10/15/20m.



HDMI Optical Cables



J2008 4K



J2008 Converter 4K



J2009 8K



J2020 VGA-GDMI Converter 4K

Version: Standard HDMI 2.0

- True 4K, compliant with international high-definition cable manufacturing standards; officially certified by the HDMI Association.
- Supports 3D video, Dolby Atmos/dts:x, and ARC (Audio Return Channel) signals.
- Resolution: Fully compatible with 4K, 2K, 1080P, and other resolutions.
- Color value (YUV/RGB): Fully supports 4:4:4, 4:4:2, and 4:4:0 color spaces.
 - ★ Image detail: 60Hz, ideal for avid gamers.
 - ★ Image quality degradation: Nearly zero attenuation, optical fiber transmission unaffected by electromagnetic interference.
 - ★ High dynamic resolution: Supports 4K HDR, providing ultra-high-definition color dynamic contrast.
- HDCP: Supports HDCP2.2/HDCP1.1 backward compatibility.
- Bandwidth transmission: 18Gbps.
- Optical fiber core: 4mm, slim, flexible, and easy to route.
- Weight-bearing and tensile strength: Tested for 25KG weight bearing, tensile and swing resistance, and high-temperature endurance up to 75° C.
- HDMI interface: Standard HDMI head + MICRO HDMI head, capable of passing through 20mm engineering conduits; detachable head can pass through 14mm engineering conduits.
- Copper shell gold-plated connector, high-strength zinc alloy shell, high-elastic flame-retardant jacket.
- Compliant with international environmental standards, offering peace of mind with multiple certifications: Enhanced version of ROHS2.0 certification and ISO9001:2015 certification.

Version

Version	2.1	2.0
Video Quality	<ul style="list-style-type: none"> ★ 3D Video ★ Supports 8K 7680x4320 Resolution ★ Supports 4K/120Hz, 8K/60Hz ★ Static HDR (HDR static data) ★ Dynamic HDR (HDR dynamic data) ★ Variable Refresh Rate (VRR) ★ Quick Media Switching (QMS) ★ Auto Low Latency Mode (ALLM) 	<ul style="list-style-type: none"> ★ 3D Video ★ Supports 4K 3840x2160 Resolution ★ Supports 4K/60Hz ★ Static HDR (HDR static data)
Audio Quality	<ul style="list-style-type: none"> ★ Supports Multiple Audio Streams ★ 32 Audio Channels ★ Automatic Audio-Video Sync ★ 1536kHz Audio Sampling Rate ★ Enhanced Audio Return Channel (eARC) 	<ul style="list-style-type: none"> ★ Supports Multiple Audio Streams ★ Supports 32 Audio Channels ★ Automatic Audio-Video Sync ★ 1536kHz Audio Sampling Rate
Speed	<ul style="list-style-type: none"> ★ 48Gbps Total Bandwidth ★ Quick Frame Transport (QFT) 	<ul style="list-style-type: none"> ★ 18Gbps Transfer Speed

HDMI 2.1 is the real deal for enthusiasts

	2.1	2.0-2.0b	1.4-1.4b
Full HD Blu-ray and HD DVD Video	✓	✓	✓
HDMI-CEC	✓	✓	✓
DVD-Audio	✓	✓	✓
Super Audio (DSD)	✓	✓	✓
Automatic Audio-Video Sync	✓	✓	✓
Dolby TrueHD/DTS-HD Master Audio	✓	✓	✓
CEC Command Upgrade	✓	✓	✓
3D Video	✓	✓	✓
Ethernet Channel (100 Mbit/s)	✓	✓	✓
Audio Return Channel (ARC)	✓	✓	✓
Multiple Audio Streams	✓	✓	X
Dual View	✓	✓	X
Hybrid Log-Gamma (HLG) HDR Function	✓	✓	X
Static HDR (HDR Static Data)	✓	X	X
Dynamic HDR (HDR Dynamic Data)	✓	X	X
Enhanced Audio Return Channel (eARC)	✓	X	X
Variable Refresh Rate (VRR)	✓	X	X
Quick Media Switching (QMS)	✓	X	X
Quick Frame Transport (QFT)	✓	X	X
Auto Low Latency Mode (ALLM)	✓	X	X
Display Stream Compression (DSC)	✓	X	X
	✓	X	✓

Using high-frequency signal optical fiber to transmit TMDS, CEC, and copper core wire to transmit control signals. It has excellent resistance to electromagnetic and radio frequency interference. The cable complies with the American Plenum certification standard and the EU UL CMP fire rating.



XLR Connectors



M903

Patent Number
ZL201730411468.4



M904

Patent Number
ZL201730411468.4



T903



T904



T903BG



T904BG

Product Description:

- 3-pin XLR male (female) connectors.
- Brand new button design.
- Unique cage insertion contact.
- Positionable cable clamp.
- Internally threaded tail protector.
- Five color-coded rings available.

Electrical Performance :

- Contact resistance: less than 0.01 Ω
- Insulation resistance: greater than 2000 Ω
- Withstanding voltage: AC250V 50Hz

Other Features :

- Durability (plug/unplug cycles): >1200 times
- Operating temperature: -30°C to +80°C

Remark:

- All accessories come with SGS test reports.
- The product complies with ROHS environmental standards.
- The product has obtained CE certification.



M903BG



M904BG



M903/M903BG

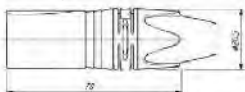

M904/M904BG

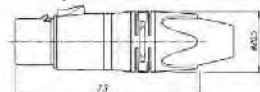

Product Description:

- 3-pin/5-pin XLR male (female) connectors.
- Brand new button design.
- Unique cage contact points.
- Positionable cable clamp.
- Internally threaded tail protector.
- Available in five color-coded rings.

Electrical Performance :

- Contact resistance: less than 0.01 Ω
- Insulation resistance: greater than 2000 Ω
- Withstanding voltage: AC250V 50Hz

Other Features :

- Durability (plug/unplug cycles): >1200 times
- Operating temperature: -30°C to +80°C

Remark:

- All accessories come with SGS test reports.
- The product complies with ROHS environmental standards.
- The product has obtained CE certification.



T9035



T9045



T9035BG



T9045BG



T903/T903BG

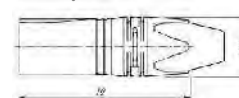

T904/T904BG

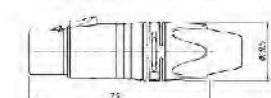

XLR Connectors

T931



T932



T931BG



T932BG



M901



M902



M901BG



M902BG



Product Description:

- XLR male (female) connectors with tool-free assembly and disassembly.
- Beryllium copper sockets ensure consistent insertion force and lifespan for each pin.
- Specially electroplated grounding tabs enhance performance and ease of soldering.
- Available with nickel or black plating on the shell, tin or gold plating on the contacts, and metal or plastic options for the tail sleeve.
- Widely used in audio, lighting, communication, and many other fields.

Electrical Performance :

- Contact resistance: less than 0.01 Ω
- Insulation resistance: greater than 2000 Ω
- Withstanding voltage: AC250V 50Hz

Other Features :

- Durability (plug/unplug cycles): >1200 times
- Operating temperature: -30°C to +80°C

Remark:

- All accessories come with SGS test reports.
- The product complies with ROHS environmental standards.
- The product has obtained CE certification.

Product Description:

- XLR male (female) connectors with tool-free assembly and disassembly.
- Beryllium copper sockets ensure consistent insertion force and durability for each pin.
- Special electroplating on the grounding tabs enhances performance and simplifies soldering.
- Shell options include nickel or black plating, contact options include tin or gold plating, and tail sleeves are available in metal or plastic.
- Widely used in audio, lighting, communication, and various other fields.

Electrical Performance :

- Contact resistance: less than 0.01 Ω
- Insulation resistance: greater than 2000 Ω
- Withstanding voltage: AC250V 50Hz

Other Features :

- Durability (plug/unplug cycles): >1200 times
- Operating temperature: -30°C to +80°C

Remark:

- All accessories come with SGS test reports.
- The product complies with ROHS environmental standards.
- The product has obtained CE certification.

T933



T934



T933

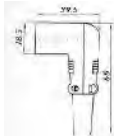

T934

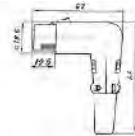

T909



T909C



M901/M901BG

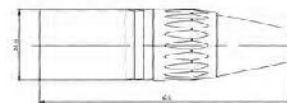

N902/N902BG

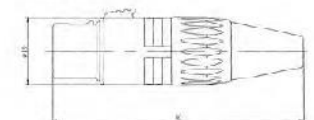

XLR Connectors

T901



T902



T901BG



T902BG



Product Description:

- 5-pin XLR male (female) connectors with tool-free assembly and disassembly.
- Beryllium copper sockets ensure consistent insertion force and durability for each pin.
- Special electroplating on the grounding tabs enhances performance and simplifies soldering.
- Shell options include nickel or black plating, contact options include tin or gold plating, and tail sleeves are available in metal or plastic.
- Widely used in audio, lighting, communication, electric vehicle chargers, and various other fields.

Electrical Performance :

- Contact resistance: less than 0.01 Ω
- Insulation resistance: greater than 2000 Ω
- Withstanding voltage: AC250V 50Hz

Other Features :

- Durability (plug/unplug cycles): >1200 times
- Operating temperature: -30°C to +80°C

Remark:

- All accessories come with SGS test reports.
- The product complies with ROHS environmental standards.
- The product has obtained CE certification.

T9015



T9025



T9015BG



T9025BG



T9015/T9015BG

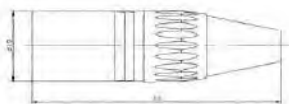

T9025/T9025BG

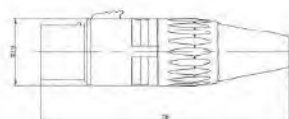

T935



T951



T952



Product Description:

- The single product housing contains a 3-pin male/female connector.
- Quickly switch between male and female connectors by moving the housing forward or backward.
- Gold-plated contacts.

T935

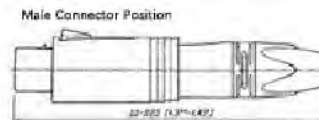

Female Connector Position

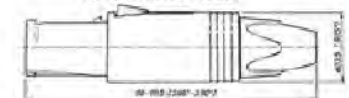

T936

Waterproof connector



T937

Waterproof connector



XLR Connectors

T316



T318



Product Description:

- 3-pin XLR male/female socket.
- D-shaped mounting dimensions.
- All contacts are gold-plated.
- Available in both vertical and 90° bent mounting options.

Performance:

- Rated voltage: 50Vac
- Rated current: 10A
- Contact resistance: less than 0.012Ω
- Insulation resistance: greater than 1000Ω
- Lifespan: >1000 cycles
- Operating environment: -30°C to 80°C

T910



T911



T912



T913



Product Description:

- 3-pin XLR male/female socket.
- D-shaped mounting dimensions.
- All contacts are gold-plated.
- Available in both vertical and 90° bent mounting options.

T910

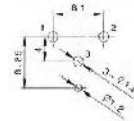

T911

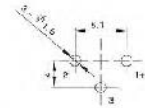

T912



T913



T316

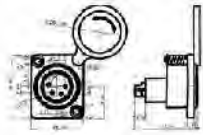

T318

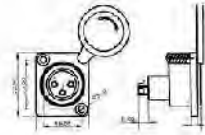

T914



T922



T914



T922

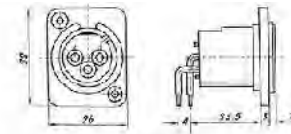

T9105



T9115



T9125



T9135



T9105

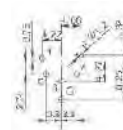

T9115

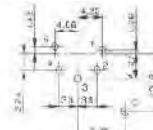

T9125

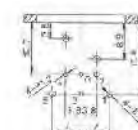

T9135



XLR Connectors

M907



M908



T907



T908



T907BG



T908BG



Product Description:

- 3-pin XLR male (female) socket.
- Zinc alloy housing.
- Housing available in nickel-plated or black-plated options.
- Pins available in tin-plated or gold-plated options.
- Standard D-shaped mounting size, suitable for both front and rear mounting.
- Compact axial dimensions, lightweight, and space-saving.

Performance:

- Rated Voltage: 50Vac
- Rated Current: 10A
- Contact Resistance: Less than 0.01Ω
- Insulation Resistance: Greater than 1000Ω
- Lifespan: Over 1000 cycles
- Operating Environment: -30°C to +80°C

Product Description:

- 3-pin XLR male (female) socket.
- Zinc alloy housing.
- Housing available in nickel-plated or black-plated options.
- Pins available in tin-plated or gold-plated options.
- Standard D-shaped mounting size, suitable for both front and rear mounting.
- Compact axial dimensions, lightweight, and space-saving.

Performance:

- Rated Voltage: 50Vac
- Rated Current: 10A
- Contact Resistance: Less than 0.01Ω
- Insulation Resistance: Greater than 1000Ω
- Lifespan: Over 1000 cycles
- Operating Environment: -30°C to +80°C

M907BG



M908BG



T907S



T908S



T9075BG



T9085BG



T907/T907BG

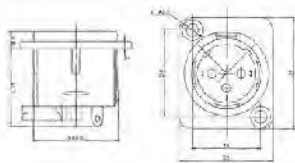

T908/T908BG

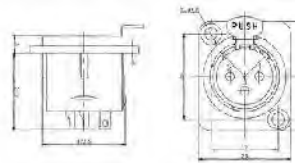

T907/T9075BG

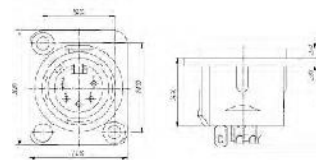

T908/T9085BG

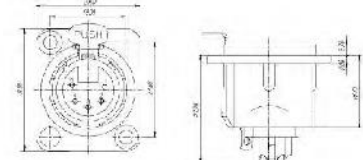

Loudspeaker Connectors

T301



T302



T302W



M301



M303



Product Description:

- High-precision copper contacts.
- Optimal quick-lock design.
- Unique contact design.
- 5 color tail sleeves available for selection.

Product Description:

- Easy installation method (composed of three parts).
- Large contact points suitable for higher power.
- M4 screws, 2.5mm pressure contact plates.
- 5 color rings available for selection.

Product Description:

- Simple and precise quick-locking system, ideal for speaker applications.
- Extra-large soldering contact points, suitable for cables up to 6mm².
- All contact parts are precision-machined copper.
- User-friendly push rod design to ensure fast locking/unlocking.

Product Description:

- High-precision copper contacts.
- Optimal quick-lock design.
- Unique contact design.
- 5 color tail sleeves available for selection.

T301

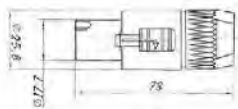

T302

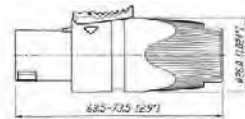

T303



T304



M301

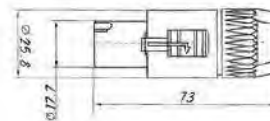

M303

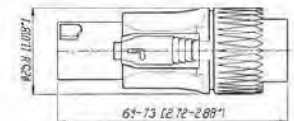

T303

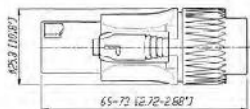

T304

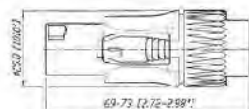

T306



T305

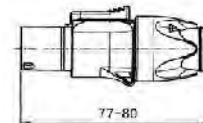

T306



T307

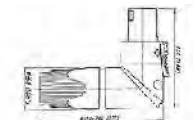

Loudspeaker Connectors

T301L



T321



T310



T310A



Product Description:

- High-precision copper contacts.
- Optimal quick-lock design.
- Unique contact design.
- 5 color tail sleeves available for selection.

Product Description:

- Large-volume tail sleeve.
- Tail with safety cover.
- Precision accessory combination.
- 5 color tails available for selection.

Product Description:

- Standard D-shaped mounting design.
- Copper contacts.
- Multiple connection options available.

Electrical:

- Contact resistance: < 3mΩ
- Insulation resistance: 21GΩ
- Dielectric strength: 4KV (peak)

Mechanical properties:

- Insertion/removal cycles: 5000

T301L

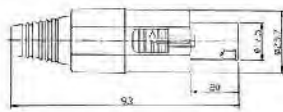

T321L

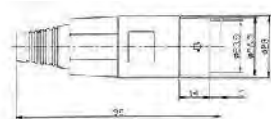

T310B



T312



T320(8P)



T320L(8P)



T320

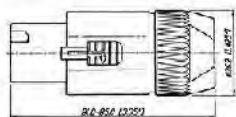

T320L

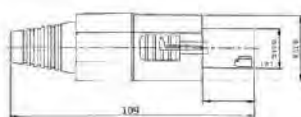

T310

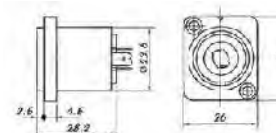

non-welded terminals



Loudspeaker Connectors

T311



T311M



T322(8P)



T314



T315



Product Description:

- The housing is made of imported engineering plastic with a user-friendly design, wear-resistant and deformation-resistant.
- Accurate latch locking system.
- Supports various mounting and connection systems.
- D-type panel opening allows for easy installation on standard panels in the audio industry.

Product Description:

- Combination of 3-pin XLR female connector and 6.35mm phone jack.
- Combines the two connectors to save installation panel space.
- Horizontal or vertical PCB hard-wire soldering or mounting.
- Extremely low conductor capacitance.
- D-type panel opening allows for easy installation on standard panels in the audio industry.

Product Description:

- Metal housing design, suitable for harsh and rugged environments.
- Accurate latch locking system.
- Supports various mounting and connection systems.
- D-type panel opening allows for easy installation on standard panels in the audio industry.

T311

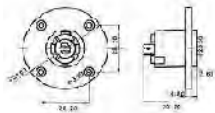

T322(8P)

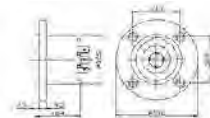

T903



T810

T314

T314

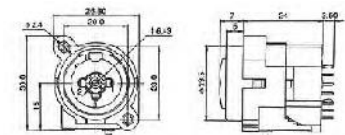

T313



T313-1



T326



T313

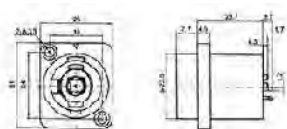

T313-1

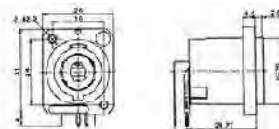

T315

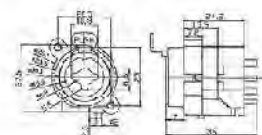

T326

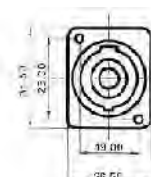

PowerCON

T701



T702



T703



T704



Product Description:

- Lockable power plug and socket.
- Used for power output (white/blue).
- Contacts are all made of high-precision copper.
- All plastic parts are flame retardant.

Performance:

- Rated Voltage: 250Vac
- Rated Current: 20Arms
- Contact Resistance: Less than 3mΩ
- Insulation Resistance: Greater than 1000Ω
- Operating Environment: -30°C to +80°C

Product Description:

- Lockable power plug and socket.
- Used for power output (white/blue).
- Contacts are all made of high-precision copper.
- All plastic parts are flame retardant.

Performance:

- Rated Voltage: 250Vac
- Rated Current: 20Arms
- Contact Resistance: Less than 3mΩ
- Insulation Resistance: Greater than 1000Ω
- Operating Environment: -30°C to +80°C

T702A



T706



T704A



T708



T701

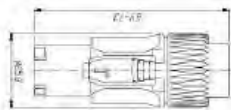

T702

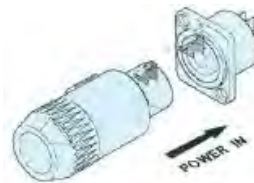
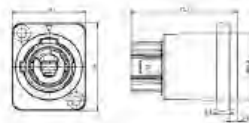

T703

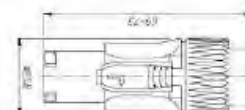

T704

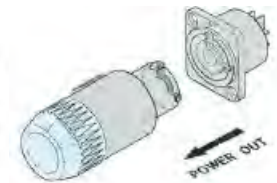
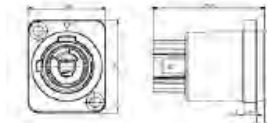

PowerCON

T703-1



T702-1



T791



T792



Product Description:

- Lockable power plug and socket.
- Used for power input (blue).
- Contacts are all made of high-precision copper.
- All plastic parts are flame retardant.

Performance:

- Rated Voltage: 250Vac
- Rated Current: 20Arms
- Contact Resistance: Less than 3mΩ
- Insulation Resistance: Greater than 1000Ω
- Operating Environment: -30°C to +80°C

Product Description:

- Newly designed waterproof power connector.
- High current capacity, rated for 20A/250BVac.
- Lockable three-pin power connector.
- Quick-lock system.

Performance:

- Rated Voltage: 250Vac
- Rated Current: 20Arms
- Contact Resistance: Less than 3mΩ
- Insulation Resistance: Greater than 1000Ω
- Operating Environment: -30°C to +80°C

T706-1



Back of T702-1



T791

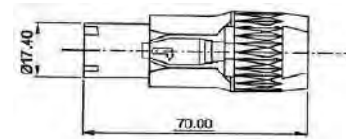

T792

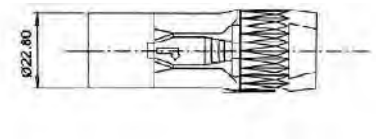

T703-1

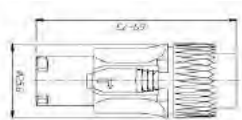

T702-1

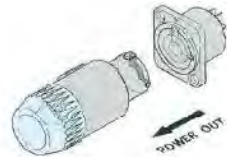
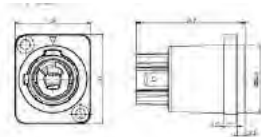

T793

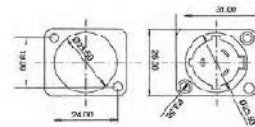

T794

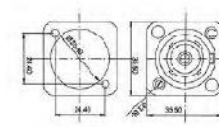

T795

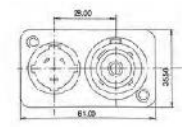

Mini XLR Connectors

T401



T402



T405



T403



T404



Product Description:

- Contacts and housing are made entirely of copper.
- Sleek design with secure contact.
- Available in 3, 4, and 5-pin options.

Performance:

- Rated Voltage: 250Vac
- Contact Resistance: 5mΩ
- Insulation Resistance: 500Vac 1000mΩ
- Insertion and Extraction Life: >2000 times
- Suitable Wire Gauge: Φ2-Φ4 / Φ3-Φ5

Product Description:

- Contacts and housing are made entirely of copper.
- Sleek design with secure contact.
- Available in 3, 4, and 5-pin options.

Performance:

- Rated Voltage: 250Vac
- Contact Resistance: 5mΩ
- Insulation Resistance: 500Vac 1000mΩ
- Insertion and Extraction Life: >2000 times
- Suitable Wire Gauge: Φ2-Φ4 / Φ3-Φ5

T401

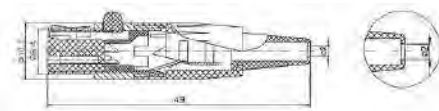

T402

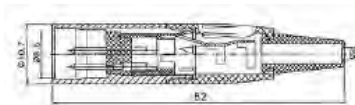

T405



T404

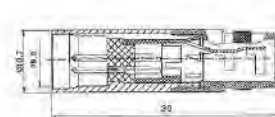

T404





1/4" Plug

T810



T810BG



T811



T811BG



T815



T815B



T808



T807G



Product Description:

- 1/4" mono/stereo plug, suitable for wire diameter ranging from 3mm to 6.5mm.
- Plastic wire clamp for easy usage.
- Contacts made of high-precision copper.
- Contacts can be plated with nickel or gold.
- Housing can be plated with white or black.
- Unique design, with a registered appearance patent.
- Available in 5 different colors for the tail sleeve.

Performance:

- Contact resistance: $\leq 10m\Omega$
- Insulation resistance: $> 200m\Omega$
- Voltage resistance: 0.5KVac 50Hz
- Insertion/extraction life: > 1000 cycles
- Operating temperature: $-30^{\circ}C$ to $80^{\circ}C$
- Suitable wire diameter: $\phi 3mm$ to $\phi 8mm$

T815/T815B

Product Description:

- 1/4" fixed mount socket with standard D-type installation dimensions.
- Equipped with a safety lock for more stable performance.
- Can be mounted from either the top or bottom of the panel.
- Metal housing for enhanced durability, with options for white or black plating.

Performance:

- Contact resistance: $< 6m\Omega$
- Insulation resistance: $> 2000m\Omega$
- Dielectric strength: 1KVac
- Rated current: 10A
- Lifespan: > 1000 cycles

T808

Product Description:

- 1/4" right angle plug.
- Gold contact nickel housing.
- Outward appearance.

Performance:

- Contact resistance: $\leq 10m\Omega$
- Insulation resistance: $> 2000m\Omega$
- Voltage resistance: 0.5KVac 50Hz
- Insertion/extraction life: > 1000 cycles
- Operating temperature: $-30^{\circ}C$ to $80^{\circ}C$
- Suitable wire diameter: 3mm to 7mm

T807G

Product Description:

- 1/4" to RCA socket.
- Contacts are made of copper and gold-plated for improved performance.
- Compact size for easy use.

Performance:

- Contact resistance: $\leq 10m\Omega$
- Insulation resistance: $> 2000m\Omega$
- Voltage resistance: 0.5KVac 50Hz
- Insertion/extraction life: > 1000 cycles

T810AG



T810AB



T805



T805BG



Patent Number
2015.30507031.1

T811/T811BG



T803G/T803BG



T810/T810BG



T805/T805BG



T803G



T803BG



T810



T802



T809



T815/815B

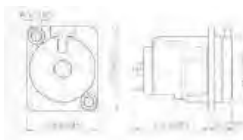

T807G

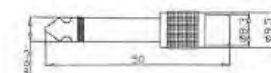

T809

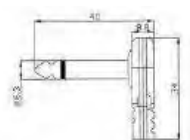

1/4" Plug

T851



T852



T853G



T53-1



T854



T855



Product Description:

- The contact components are made from brass, ensuring low contact resistance.
- The soldering parts are silver-plated, offering excellent conductivity and good solderability.
- The housing is made of metal, providing high strength and impact resistance, ensuring premium signal transmission.
- The surface is treated with a special electroplating process, resulting in a novel and aesthetically pleasing coating that resists corrosion over time.
- All materials comply with ROHS environmental standards.

Product Description:

- The contact components are made from brass, ensuring low contact resistance.
- The soldering parts are silver-plated, offering excellent conductivity and good solderability.
- The housing is made of metal, providing high strength and impact resistance, ensuring premium signal transmission.
- The surface is treated with a special electroplating process, resulting in a novel and aesthetically pleasing coating that resists corrosion over time.
- All materials comply with ROHS environmental standards.

T851

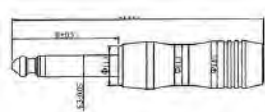

T852

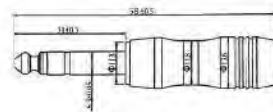

T853G



T854



T805G



T805BG-1



T809B



T862

6.35mm stereo plug 3.5mm jack



T805G

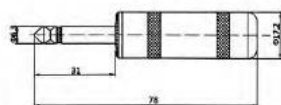

T809B

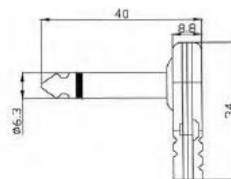

T862

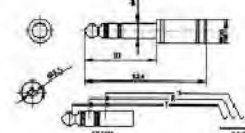

T853-1

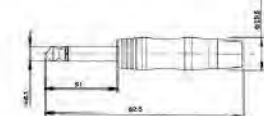

3.5 Plug

T816



T816-1



T816-2



Product Description:

- 6.35mm Mono/Stereo Flame Retardant Plastic Socket.
- The product head can be provided with semi-threaded, full-threaded, or chrome-plated sleeve options.
- The socket front is equipped with a washer and a fixed nut, designed for horizontal installation and suitable for both hardwiring and PCB products.

Performance:

- Contact Resistance: $\leq 10\text{m}\Omega$
- Insulation Resistance: $> 2000\text{m}\Omega$
- Insertion Force: $\leq 5\text{-}40\text{N}$
- Service Life: > 1000 cycles

T816-1

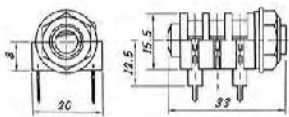

T816-2

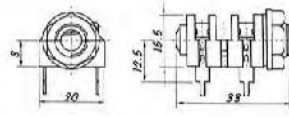

T817



T817-1



T834



T817

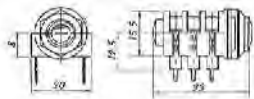

T817-1

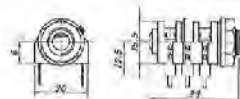

T834

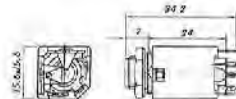

T821



T821BG



T822BG



T823G



T823LG



Product Description:

- 3.5mm Stereo Plug.
- The contact and wire clamp are made of copper.
- The shell can be plated in white or black.
- The contacts can be plated with nickel or gold.
- T821/T821BG: Suitable for wire diameters from $\Phi 2$ to $\Phi 6.5$.
- T822BG: Suitable for wire diameters from $\Phi 7$ to $\Phi 9$.
- T823BG: Available with 5 color options for the tail sleeve.

Performance:

- Insulation Resistance: $> 2\text{G}\Omega$
- Insulation Strength: 1KVac
- Service Life: > 1000 cycles

T823BG



T823LBG



Patent Number
2015.31607034.5



T825



T832



T821/T821BG

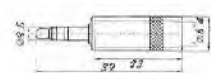

T822BG

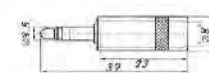

T823BG



3.5 Plug

T826



T827



T828



Product Description:

- 3.5mm Stereo Plug.
- Nickel-plated brass shell with gold-plated contacts.
- Suitable for cables with a diameter less than 5mm.

Product Description:

- 3.5mm Stereo Soldering Plug.
- Available in five color options.
- Suitable for audio cables with a diameter of 4mm (small diameter) or below.
- Gold-plated plug with a unique contact design.
- Pure copper shell ensures secure and tight connection, not easily rotated.

T852-1



T853



Product Description:

- 3.5mm Stereo Socket for Mono or Stereo Applications.
- Standard D-type installation size.
- Features a safety lock for more stable performance.
- Can be installed from either the top or bottom of the panel.
- Metal shell for better durability, available in white or black plating.

Product Description:

- 3.5mm Stereo to 6.35mm Plug Adapter.
- Precision-machined contacts without rivets.
- Smooth and attractive design for convenience and speed.
- Nickel-plated shell with a stylish, durable molded exterior.

T829



T830



T861

3.5mm stereo plug 6.35mm jack



Patent Number
2015.31057034.5

Back of T861



T829



T830



T861



T861

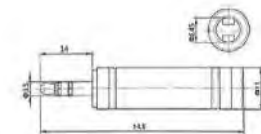

RCA Connector

T605



T606



T607



T601-R



Patent Number
ZL 2015.30506962.X

Product Description:

- The contacts are made of copper.
- The contacts can be nickel-plated or gold-plated.
- The shell can be plated in white or black.
- The wire clamp is made of copper.
- Five color options for the tail sleeve.

Performance:

- Rated current: 16A
- Rated voltage: 50V AC
- Insulation resistance: >100GΩ
- Insulation strength: 1.5KVAC
- Service life: >2000 times

Product Description:

- The entire product is made of copper, except for the insulation.
- Unique design with a locking function.
- All contacts are gold-plated.

T610A



T610B



T611



T606

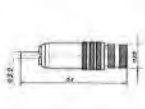

T601-R

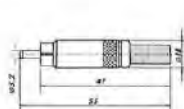

T611

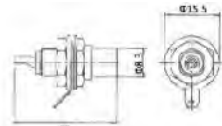

BNC Connector

T153



T155



Product Description:

- The shell is made of aluminum alloy, machined with a turning process, and treated with electrophoretic surface technology.
- Soldering-type digital HD video connector.
- The PTFE insulation layer with an air gap ensures stability.
- 75-ohm impedance beryllium copper external contact ring, resistant to frequent mating cycles.
- Ergonomically designed for a comfortable grip.

Product Description:

- Standard D-type installation size.
- Can be externally or internally mounted.
- Gold-plated contacts.
- The shell can be plated in white or black.

Performance:

- Rated current: 16A
- Rated voltage: 50V AC
- Insulation resistance: >5GΩ
- Insulation strength: 0.5KVAC
- Service life: >2000 times

T151



T151B



T152



T152B



T152

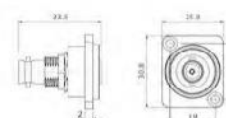

T151/T151B

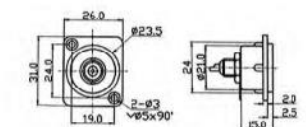

Ethercon Data Connectors

T201



T201B



T205



T205 Tail End Diagram
Horizontal Installation

T206



T206 Tail End Diagram
Vertical Installation

Product Description:

- BJ45 plug, designed for harsh environments.
- Ensures stable signal connection, preventing disconnection or loosening.
- Hard zinc alloy shell to protect internal components from damage.
- Available in black and white for shell color options.

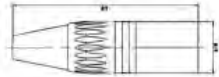

Product Description:

- Fixed installation RJ45 interface.
- The rear pins are available in parallel (T205) and vertical (T206) versions.
- The T208 series rear end features an intelligent disk controller.
- Can be mounted from the top or from inside.

Performance:

- Number of contacts: 8
- Rated current per contact: 1.5A
- Rated voltage: <50V AC
- Contact resistance: <10mΩ
- Insulation resistance: >500MΩ
- Insulation strength: >1000VACrms
- Cover frequency: 1-100MHz

T210



T211



T212



T213



T208-1



T208-2



T28-3



T210

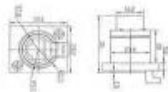

T211

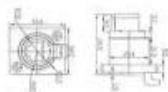

T212

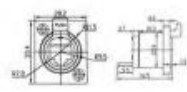

T213

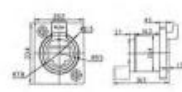

T205

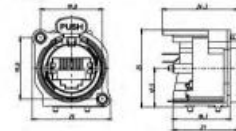

T206

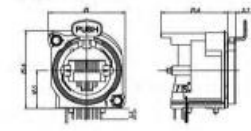

Ethercon Data Connectors

T160
USB AF/AF



T160-1
USB AF/AF



T160-2
USB AF/AF



T160-2
USB AF/AF



T180
HDMI F/F 1.3V



T180-1
HDMI F/F



T180-2
HDMI F/F



T180-3
HDMI F/F



T180-4
HDMI F/F



Product Description:

- This product is suitable for audio and video connections.
- D-type mounting size.
- Made with high-quality conductive materials and imported plastic injection molding.

Product Description:

- Available in 9-pin and 15-pin versions.
- Offers "male-to-female" and "female-to-male" products.
- Integrated molding for minimal signal attenuation, supporting high-definition video signal transmission.
- Compact and convenient design, easy to carry and use, plug and play.

Product Description:

- Lossless signal, stable transmission, plug and play, portable.
- 24K gold-plated connectors, Reach-compliant.
- All components made of environmentally-friendly, flame-retardant materials.

Product Description:

- Gold-plated pins for oxidation resistance and excellent contact performance.
- Standard wiring sequence, made from high-quality PC polycarbonate.
- Phosphor bronze wire clips with 1000 connection cycles.

T140
6P4C F/terminal



T140-1
6P4C F/terminal



T140-2
6P4C F/terminal



T170
VGA F/F



T170-1
VGA/F



T170-2
VGA



T170-4
VGA/F



T160

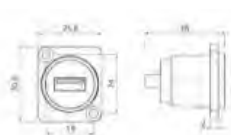

T140

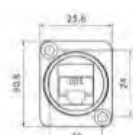

T170



T180

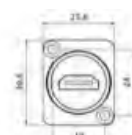

Ethercon Data Connectors

T190
LAN F/F



T190-1
LAN F/F



T190-2
LAN F/pressure
welding



T190-3
LAN F/pressure
welding



T191



Product Description:

- RJ45 plug with copper core contact points, gold-plated.
- Made from PC material with a fire rating of 94-V0.
- High-strength phosphor bronze.
- Over 750 insertion and removal cycles.

T190
LAN F/F

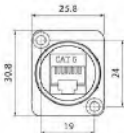

**8-core Hand-in-Hand
Conference Module**



**6-core Hand-in-Hand
Conference Module**



Binding post/"Banana" plug

T631



T632



Product Description:

- High-end crystal binding post with a crystal shell and long tail, resistant to oxidation, minimal distortion, and high quality.
- The main part is copper, with a gold-plated surface, designed for audiophile DIY projects.
- Primarily used for amplifier chassis binding posts and speaker binding posts.

Performance:

- Professional banana plug with gold-plated contacts and a metal housing.
- The banana plug features a lantern-style structure with spring clips that expand outward to increase the contact area, improving transmission and elasticity.
- Unlike ordinary banana plugs, this one maintains elasticity even after pressure is applied.
- No soldering required, secured with dual-sided screws.



T621



T622



M12/M16 SERIES

	No. of contacts	Order Code
	2	M12F2
	3	M12F3
	4	M12F4
	5	M12F5
	6	M12F6
	7	M12F7
		2
3		M12M3
4		M12M4
5		M12M5
6		M12M6
7		M12M7
		2
	3	M12D3
	4	M12D4
	5	M12D5
	6	M12D6
	7	M12D7

Technical:

- Current/Voltage: 5A/250V
- Withstand voltage (AC.V): 1M/1500
- Insulation impedance (MΩ): DV500V/2000

	No. of contacts	Order Code
	2	M16F2
	3	M16F3
	4	M16F4
	5	M16F5
	6	M16F6
	7	M16F7
	8	M16F8
	9	M16F9
	10	M16F10
		2
3		M16M3
4		M16M4
5		M16M5
6		M16M6
7		M16M7
8		M16M8
9		M16M9
10		M16M10
		2
	3	M16C3
	4	M16C4
	5	M16C5
	6	M16C6
	7	M16C7
	8	M16C8
	9	M16C9
	10	M16C10

Technical:

- Current/Voltage: 5A/250V
- Withstand voltage (AC.V): 1M/1500
- Insulation impedance (MΩ): DV500V/2000

M16/M20 SERIES

	No. of contacts	Order Code
	2	M16D2
	3	M16D3
	4	M16D4
	5	M16D5
	6	M16D6
	7	M16D7
	8	M16D8
	9	M16D9
	10	M16D10
		2
3		M16W3
4		M16W4
5		M16W5
6		M16W6
7		M16W7
8		M16W8
9		M16W9
10		M16W10
		2
	3	M16L3
	4	M16L4
	5	M16L5
	6	M16L6
	7	M16L7
	8	M16L8
	9	M16L9
	10	M16L10

Technical:

- Current/Voltage: 5A/250V
- Withstand voltage (AC.V): 1M/1500
- Insulation impedance (MΩ): DV500V/2000

	No. of contacts	Order Code
	2	M20F2
	3	M20F3
	4	M20F4
	5	M20F5
	6	M20F6
	7	M20F7
	8	M20F8
	9	M20F9
	10	M20F10
		2
3		M20M3
4		M20M4
5		M20M5
6		M20M6
7		M20M7
8		M20M8
9		M20M9
10		M20M10
		2
	3	M20L3
	4	M20L4
	5	M20L5
	6	M20L6
	7	M20L7
	8	M20L8
	9	M20L9
	10	M20L10
		2
2		M20D3
2		M20D4
2		M20D5
2		M20D6
2		M20D7
2		M20D8
2		M20D9
2		M20D10

Technical:

- Current/Voltage: 5A/250V
- Withstand voltage (AC.V): 1M/1500
- Insulation impedance (MΩ): DV500V/2000

Adapter



Electrical Specification:

Contact resistance ≤5MΩ	Insulation resistance ≥5000MΩ	Withstand voltage 1400V
----------------------------	----------------------------------	----------------------------

Mechanical Property:

Axial fixation: 210N	One foot splitting force: 85+1g	Insertion and extraction force: 10-80N
----------------------	---------------------------------	--

Product Description:

- Can be equipped with a 1:4 isolation transformer, impedance 200:3.2k.
- Can be equipped with a 1:1 isolation transformer, impedance 200:200 (see diagram B).
- Sturdy aluminum alloy casing.
- Different sockets can be equipped according to different requirements (see Chart A).

Audio Transformer Specifications:

- 1:4 impedance ratio: 200:3.2k
- Source/Load impedance: 200/10k
- 1:1 impedance ratio: 200:200
- Source/Load impedance: 600/10k
- A low-cost solution for unbalanced/balanced line conversion and passive DI applications, where no earth or gain switching is required.
- Max. input level @ 50Hz at 1% THD: -3 dBu
- Max. input level @ 50Hz at 1% THD: -7 dBu



T907BG	T908BG	T9075BG	T9085BG	T310	T702	T704	T751	T610B	T815B

PASSIVE DIRECT INJECTION BOX



Introduction:

- DI001 is a passive, stand-alone direct injection box, ideal for bass guitars, acoustic instruments, electric guitars, keyboards, and synthesizers for audio signal pickup.
- The output is isolated by a transformer, and a ground lift switch is included to help combat ground loops. The left side is capacitor-linked to the ground, while the right side offers a full grounding chassis connection.
- It features very low harmonic and phase distortion, and its compact, rugged design ensures durability.

Specification:

Order Code	DI001
Freq. Response	0 - 2.8dB (20 Hz to 20 kHz)
Distortion	0.003% (0 dBu 1kHz)
Insertion Loss	<0.5 dB into 600 ohms load
	<0.01 dB into 50k ohms load
Construction	Metal
Dimension	103 x 69 x 35mm
Connections	XLR 3-pole male isolated Output
	6.35mm 2 pole jack Input
	6.35mm 2 pole jack Thru
	Ground Lift Switch (GND)



Introduction:

- DI002 is a premium direct box that combines two units in a single case. With its rugged, roadworthy construction and two shielded transformers, it provides high-quality signal connection solutions for a variety of live sound and recording applications. The DI002 is perfect for converting unbalanced stereo line level or instrument signals from keyboards, electronic drum kits, acoustic-electric guitars, and more.
- The Thru jacks allow you to tap off the signals from the inputs and pass them to amplifiers or monitors without affecting the original audio. This feature eliminates the need for miking guitar amplifiers, which may be preferable depending on your application.

Specification:

Order Code	DI002
Freq. Response	0 - 2.8dB (20 Hz to 20 kHz)
Distortion	0.003% (0 dBu 1kHz)
Insertion Loss	0.5 dB into 600 ohms load
	<0.1 dB into 50k ohms load
Construction	All metal construction with rubber feet
Dimension	122x105x40mm
Connections	6.35mm 2 pole jack Input x 2
	RCA Input x 2
	3.5mm stereo jack Input
	XLR 3-pole male Output + XLR 3-pole male Output Σ
	Ground Lift Switch (GND)
	MONO SUM Σ

Audio Noise Reduction Protector



The importance of a good audio connector:

A good audio connector is essential. Many live sound setups require laptops as audio players. However, the unbalanced signal from the laptop to the mixer has poor interference resistance and can cause ground loop noise, leading to serious hum from the speakers, affecting sound quality. This is a common issue for audio engineers.

This product isolates and reduces noise, solving hum caused by electrical interference. It features a scientific turn ratio, premium materials, and optimal impedance balance for perfect power and load matching.

It is ideal for live performance audio systems, isolating noise between the audio system, projectors, LED screens, and lighting equipment. It also reduces background noise in band setups.

The noise protector uses high-quality imported components, minimizing high-frequency loss while preserving the original sound quality, unlike most domestic isolation transformers that degrade high frequencies.

Applicable situation:

- Current noise
- Power interference
- Static isolation
- AC noise
- Ground loop potential difference
- Noise generated in broadcasting systems
- Common-source noise
- Simultaneous interpretation, video conferencing, TV conferencing
- Noise from mixing consoles connected to computers, LED video, cameras, and other systems
- Eliminate noise from simultaneous interpretation equipment and mixing consoles
- Eliminate noise from electronic instruments connected to the mixing console
- Eliminate noise from laptops connected to the mixing console
- Eliminate noise from cameras and amplifiers connected to the sound system
- Eliminate current noise generated by non-grounded equipment connections
- Improve sound quality and eliminate digital sound distortion
- Static isolation and lightning protection for mixing consoles
- Prevent high potential differences from damaging connections



HDMI SPLITTER

TH104 HDMI SPLITTER 1x4 VER 1.4
TH108 HDMI SPLITTER 1x8 VER 1.4
TH104B
TH108B



- The 1 to 4 HDMI splitter can connect 1 HD signal source to 4 HD display terminals. It can easily allocate a high-definition signal from a high-definition signal source to four monitors or projectors that support HD signals. In addition, the HDMI signal can be amplified when it is connected to a signal output terminal of an HDMI cable. This HDMI allocator can support all resolutions up to 3840x2160/30Hz.

Introduction:

- HDMI splitter 1 to 2. Let an HDMI port assign two HDMI ports to the HD video allocator.
- It supports 480p, 576p, 720p, 1080i, 1080p, 4Kx2K.
- Supports 3D video format.
- Supports audio encoding formats DTS-HD/Dolby True HD/LPCM 7.1/DTS/Dolby AC3/DSD.
- Fully compatible with HDCP.
- TH102A version 1.4.
- TH102B version 2.0. Max single link range 3840x2160p 60Hz.

TH102A HDMI SPLITTER 1x2 VER 1.4
TH102A HDMI SPLITTER 1x2 VER 1.4
TH102B HDMI SPLITTER 1x2 VER 2.0
TH102B HDMI SPLITTER 1x2 VER 2.0



HDMI Distributor Switch



HDMI SWITCHER

- The HDMI switcher can support switching ports to the display terminal via remote control or manually. This HDMI switcher can support all HD formats, including 720p, 1080i, 1080p, and 3840x2160p, with multichannel audio.



TH301 HDMI SPLITTER 3x1 VER 1.4
TH401B HDMI SPLITTER 4x1 VER 1.4
TH501 HDMI SPLITTER 5x1 VER 1.4
TH401A HDMI SPLITTER 4x1 VER 2.0

HDMI Adapter



90-degree HDMI Male to Female Adapter
 DP Male to DP Female Adapter
 DP Male to Mini DP Female Adapter
 HDMI Three-in-One Adapter

Patch Panel



T12



T16



DT12



T12-1



T48



T12-180



T12-190

Features:

- Introduction: 8, 12, 16 signal channels.
- Optional installation of various connectors (see Table A).
- Standard installation size.

Features:

- 48-channel patch panel.
- Metal bracket.
- Standard installation size.

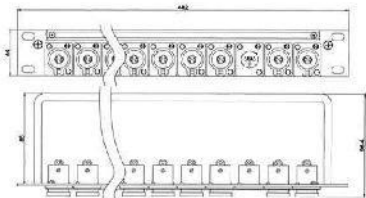

T16

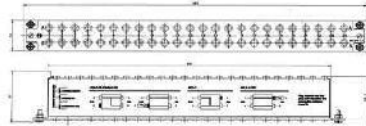

T12-240



T12-310



T12-610B



T12-702A



T12-815B



T12-907B



T12-908B



PDU Power Panel



PDU16

Empty Wall Mount Panel



Features:

- High-quality brushed aluminum alloy panel, elegant and stylish.
- Sturdy and durable.
- Can be assembled with 1-4 D-type information modules in any combination.



Professional Wall/Floor Mounted Aluminum/Copper Box 86



Features:

- High-quality brushed aluminum alloy panel with a flat design, robust craftsmanship, and strong durability.
- Separate panel and bottom box design for easy installation and soldering.
- Hidden panel mounting screw holes, with two magnetic side strips for securely locking the edge panel, ensuring a neat appearance and convenient installation and removal.
- Modular functionality, allowing customizable assembly of 1-32 D-type audio and video information modules, including HDMI, USB, network, telephone, video, BNC, 3.5mm audio, 6.5mm audio, optical fiber, power, speaker, XLR, RCA, and TV connectors.



Model	Panel Size(L*W) mm	Bottom Size(L*W*H) mm
Q201	225*125*4	205*105*90
Q300	320*125*4	300*105*90
Q401	225*220*4	205*200*90
Q600	320*220*4	300*200*90
Q800	415*220*4	395*200*90

Professional Wall/Floor Mounted Aluminum/Copper Box 86



Z101



Z201



Z301



Z401



D100



D200



D300



D400

Features:

- High-quality brushed aluminum alloy panel with a flat design, robust craftsmanship, and strong durability.
- Separate panel and bottom box design for easy installation and soldering.
- Hidden panel mounting screw holes, with two magnetic side strips for securely locking the edge panel, ensuring a neat appearance and convenient installation and removal.
- Modular functionality, allowing customizable assembly of 1-32 D-type audio and video information modules, including HDMI, USB, network, telephone, video, BNC, 3.5mm audio, 6.5mm audio, optical fiber, power, speaker, XLR, RCA, and TV connectors.

Features:

- 86 panel modular functionality allows customizable assembly of 1-24 D-type audio and video information modules, including HDMI, USB, network, telephone, video, BNC, 3.5mm audio, 6.5mm audio, optical fiber, power, speaker, XLR, RCA, and TV connectors. The specially designed height of the bottom box information panel can be adjusted as needed.

Model	Panel Size(L*W) mm	Bottom Size(L*W*H) mm
Z101	145*130	132*112*75
Z201	210*130	190*115*100
Z301	295*130	280*115*100
XT-2	263*130	220*110*200
XT-4	263*240	220*200*200
XT-6	370*240	330*200*230



D101



D201



D401



D601

Model	Panel Size(L*W) mm	Bottom Size(L*W*H) mm
D100	120*125	100*105*80
D200	235*125	220*110*110
D400	235*235	220*220*100
D101	120*120	110*110*85
D201	230*130	210*110*90
D401	250*220	230*200*100
D601	350*220	325*195*150



QG401



QG201



Model	Panel Size(L*W) mm	Bottom Size(L*W*H) mm
QG201	250*148	235*135*65
QG300	320*148	296*135*65
QG401	223*245	200*232*91
QG600	320*245	296*232*91
QG800	442*245	419*232*91

Cable Tester



Features:

- The cable tester is our intelligent, CPU-controlled tester, capable of checking seven types of typical sound connectors and their connecting cables for damage or incorrect wiring.
- Test results are visually displayed by LEDs.
- The power supply, a 9V battery, is installed in a slide-in compartment for easy replacement.

GST GEAR



GST GEAR



GST GEAR/Sales.Vegas



<https://www.facebook.com/profile.php?id=61553715008506>



<https://www.instagram.com/usgstgear/>

GLOBAL STAGE TECHS INC.

Las Vegas Address: 1980 S. Rainbow Blvd., Las Vegas, Nevada, USA, 89146
Corpus Christi Address: 218 N. Chaparral St., Corpus Christi, Texas, USA, 78401
E-mail: usoffice@gstgr.com
Tel: +1-315-212-6238/+1-702-612-6031

Web: www.gstgr.com

THANKS

Product | Creative and Production | Studio
for the Culture and Entertainment

Revolutionizing the Future of Entertainment Together